

॥श्रद्धा॥

॥सबुरी॥

CALENDAR  
2026

CALENDAR  
2026

**SAI TEMPLE MALVERN**

170 Planebrook Rd, Malvern, PA 19355. Tel : 610-296-2039, 510-644-2596

[www.saitemplemalvern.com](http://www.saitemplemalvern.com) | [info@saitemplepa.com](mailto:info@saitemplepa.com)

**Every**  
**Monday 6:30 pm**  
**Shiva Abhishekam**

**Every**  
**Thursday 10:30 am**  
**Baba Abhishekam**

**Every**  
**2nd Tuesday 6:30 pm**  
**Muragan Abhishekam**

**Every**  
**1st Friday 6:30 pm**  
**Sri Chakra Abhishekam**

**Every**  
**Saturday 10:30 am**  
**Balaji Abhishekam**



**Every**  
**Sankatahara**  
**Chaturthi 6:30 pm**  
**Ganapathi**  
**Abhishekam**

**Every**  
**Full Moon day**  
**Group**  
**Satyanarayana**  
**Vratam**

**Every Last**  
**Saturday 6:30 pm**  
**Ayyappa Padi Pooja**



# SAI TEMPLE MALVERN



# JANUARY 2026



170 Planebrook Rd, Malvern, PA 19355  
Tel : 610-296-2039, 510-644-2596  
www.saitemplemalvern.com  
info@saitemplepa.com

VISVAVASU, AYANA : DAKSHINA – UTTARA, RITU : SHISHIRA, PUSHYA – MAGHA, DHANUSH – MAKARA, MARGAZHI – THAI

## SUN (BHANU) MON (INDU) TUE (BHAUMA) WED (SAUMYA) THU (BRUHASPATHI) FRI (BHRUGU) SAT (STHIRA)

SUN (BHANU)	MON (INDU)	TUE (BHAUMA)	WED (SAUMYA)	THU (BRUHASPATHI)	FRI (BHRUGU)	SAT (STHIRA)
<b>FESTIVALS</b> 01 NEW YEAR'S DAY 02 PURNIMA VRATAM 06 SANKATAHARA CHATURTHI 13 BHOGI SHATTILA EKADASHI	14 MAKARA SANKRANTI PONGAL, UTTARAYANA 15 KANUMA PRADOSHA VRATAM 16 MASA SHIVARATRI 23 VASANT PANCHAMI	23 SKANDA SASHTI 25 RATHA SAPTAMI BHISHMA ASHTAMI 28 JAYA EKADASHI 29 BHISHMA DWADASHI 30 PRADOSHA VRATAM	 HAPPY MAKARA SANKRANTI	<b>1</b>  T: TRAYODASHI 11:52 N: ROHINI 12:18 VA: 17:16-18:41 RK: 13:16-14:27 YG: 07:24-08:34 SR: 07:24 SS: 16:47	<b>2</b> T: CHATURDASHI 08:23 T: PURNIMA 29:02+ N: MRIGASHIRA 09:34 N: ARDRA 30:57+ VA: 17:03-18:29 RK: 10:56-12:06 YG: 14:27-15:38 SR: 07:24 SS: 16:48	<b>3</b> T: PRATIPADA 25:59+ N: PUNARVASU 28:41+ VA: 17:49-19:16 RK: 09:45-10:56 YG: 13:17-14:28 SR: 07:24 SS: 16:49
<b>4</b> T: DWITIYA 23:26 N: PUSHYA 26:55+ VA: 12:05-13:34 RK: 15:39-16:50 YG: 12:07-13:18 SR: 07:24 SS: 16:50	<b>5</b> T: TRITIYA 21:31 N: ASHLESHA 25:47+ VA: 15:07-16:38 RK: 08:35-09:46 YG: 10:57-12:08 SR: 07:24 SS: 16:51	<b>6</b> T: CHATURTHI 20:22 N: MAGHA 25:26+ VA: 13:37-15:11 RK: 14:30-15:41 YG: 09:46-10:57 SR: 07:24 SS: 16:52	<b>7</b> T: PANCHAMI 20:03 N: P.PHALGUNI 25:54+ VA: 09:35-11:13 RK: 12:08-13:20 YG: 08:35-09:46 SR: 07:24 SS: 16:53	<b>8</b> T: SHASHTHI 20:35 N: U.PHALGUNI 27:10+ VA: 09:29-11:10 RK: 13:20-14:31 YG: 07:24-08:35 SR: 07:24 SS: 16:54	<b>9</b> T: SAPTAMI 21:53 N: HASTA 29:10+ VA: 12:16-14:00 RK: 10:58-12:09 YG: 14:32-15:43 SR: 07:24 SS: 16:55	<b>10</b> T: ASHTAMI 23:50 N: CHITRA FULL NIGHT VA: 14:00-15:46 RK: 09:47-10:58 YG: 13:21-14:33 SR: 07:24 SS: 16:56
<b>11</b> T: NAVAMI 26:12+ N: CHITRA 07:42 VA: 13:58-15:46 RK: 15:45-16:57 YG: 12:10-13:22 SR: 07:23 SS: 16:57	<b>12</b> T: DASHAMI 28:47+ N: SWATI 10:35 VA: 16:53-18:41 RK: 08:35-09:47 YG: 10:59-12:10 SR: 07:23 SS: 16:58	<b>13</b> T: EKADASHI 31:22+ N: VISHAKHA 13:36 VA: 18:06-19:54 RK: 14:35-15:47 YG: 09:47-10:59 SR: 07:23 SS: 16:59	<b>14</b> T: DWADASHI FULL NIGHT N: ANURADHA 16:33 VA: 22:48-24:35+ RK: 12:11-13:23 YG: 08:35-09:47 SR: 07:22 SS: 17:00	<b>15</b> T: DWADASHI 09:46 N: JYESHTHA 19:17 VA: 28:06+29:51+ RK: 13:24-14:36 YG: 07:22-08:34 SR: 07:22 SS: 17:01	<b>16</b> T: TRAYODASHI 11:51 N: MULA 21:42 VA: 19:56-21:42 RK: 10:59-12:12 YG: 14:37-15:50 SR: 07:22 SS: 17:02	<b>17</b> T: CHATURDASHI 13:33 N: P.ASHADHA 23:44 VA: 08:07-09:51 RK: 09:47-11:00 YG: 13:25-14:38 SR: 07:21 SS: 17:03
<b>18</b> T: AMAVASYA 14:51 N: U.ASHADHA 25:22+ VA: 08:16-09:59 VA: 29:34+31:15+ RK: 15:52-17:05 YG: 12:13-13:26 SR: 07:21 SS: 17:05	<b>19</b> T: PRATIPADA 15:44 N: SHRAVANA 26:36+ VA: 30:45+08:24 on 20 <sup>th</sup> RK: 08:33-09:47 YG: 11:00-12:13 SR: 07:20 SS: 17:06	<b>20</b> T: DWITIYA 16:12 N: DHANISHTHA 27:28+ VA: 14:40-15:53 RK: 09:46-11:00 SR: 07:20 SS: 17:07	<b>21</b> T: TRITIYA 16:17 N: SHATABHISHA 27:57+ VA: 10:49-12:26 RK: 12:14-13:27 YG: 08:33-09:46 SR: 07:19 SS: 17:08	<b>22</b> T: CHATURTHI 15:58 N: P.BHADRAPADA 28:03+ VA: 10:22-11:59 RK: 13:28-14:42 YG: 07:18-08:32 SR: 07:18 SS: 17:09	<b>23</b> T: PANCHAMI 15:16 N: U.BHADRAPADA 27:46+ VA: 13:32-15:07 RK: 11:00-12:14 YG: 14:42-15:56 SR: 07:18 SS: 17:10	<b>24</b> T: SHASHTHI 14:09 N: REVATI 27:05+ VA: 15:25-16:59 RK: 09:46-11:00 YG: 13:29-14:43 SR: 07:17 SS: 17:12
<b>25</b> T: SAPTAMI 12:40 N: ASHWINI 26:02+ VA: 22:13-23:45 RK: 15:58-17:13 YG: 12:15-13:29 SR: 07:16 SS: 17:13	<b>26</b> T: ASHTAMI 10:47 N: BHARANI 24:38+ VA: 11:05-12:35 RK: 08:30-09:45 YG: 11:00-12:15 SR: 07:16 SS: 17:14	<b>27</b> T: NAVAMI 08:35 T: DASHAMI 30:05+ N: KRITTIKA 22:56 VA: 11:47-13:17 RK: 14:45-16:00 YG: 09:45-11:00 SR: 07:15 SS: 17:15	<b>28</b> T: EKADASHI 27:25+ N: ROHINI 21:01 VA: 13:40-15:08 VA: 26:09+27:37+ RK: 12:15-13:31 YG: 08:29-09:45 SR: 07:14 SS: 17:16	<b>29</b> T: DWADASHI 24:39+ N: MRIGASHIRA 18:59 VA: 26:40+28:08+ RK: 13:31-14:46 YG: 07:13-08:29 SR: 07:13 SS: 17:18	<b>30</b> T: TRAYODASHI 21:55 N: ARDRA 16:57 VA: 28:00+29:29+ RK: 11:00-12:16 YG: 14:47-16:03 SR: 07:12 SS: 17:19	<b>31</b> T: CHATURDASHI 19:22 N: PUNARVASU 15:04 VA: 22:32-24:01+ RK: 09:44-11:00 YG: 13:32-14:48 SR: 07:11 SS: 17:20

PANCHANGA BY DR. MURALI BHUVANAGIRI CALCULATED AS PER MALVERN, PA, USA'S LONGITUDE & LATITUDE, WHEN TITHI OR NAKSHATRA ENDS PAST MIDNIGHT "MON/DATE" IS INDICATED AS HINDU DAY IS FROM ONE SUNRISE TO ANOTHER SUNRISE. TITHI, NAKSHATRA TIMINGS ARE END TIMES, WHEN ONE ENDS ANOTHER BEGINS. '+' SYMBOL INDICATES NEXT DAY

**THE MORTGAGEIST**  
YOUR MORTGAGE SPECIALIST

**Apeksha Sista** NMLS# 2692605  
**(610) 836-2332**

**Kumar Sista** NMLS# 2369551  
**(610) 618-0618**

Your Very Own Loan Officer

The Mortgageist, NMLS# 2710734, 150 Allendale Rd, Ste. 2200, King of Prussia, PA 19406

**EXPERIOR**  
FINANCIAL GROUP, INC

**Srikanth Katupilla**  
724 689 7999  
skatupilla@experiorfinancialgroup.com

**Ashish Joshi**  
717 395 6154  
ajoshi@experiorfinancialgroup.com

- College Saving Plans
- Tax Saving Plans
- Mortgage Protection
- Retirement Strategies
- Business Coaching & Mentoring

Estate Planning / Will and Trust  
Credit Score Fix Services  
Wealth building, protection & recovery  
Legal Protection Services  
Life Insurance & Long term Care



Every  
Monday 6:30 pm  
Shiva Abhishekam

Every  
Thursday 10:30 am  
Baba Abhishekam

Every  
2nd Tuesday 6:30 pm  
Muragan Abhishekam

Every  
1st Friday 6:30 pm  
Sri Chakra Abhishekam

Every  
Saturday 10:30 am  
Balaji Abhishekam

Every  
Sankatahara  
Chaturthi 6:30 pm  
Ganapathi  
Abhishekam

Every  
Full Moon day  
Group  
Satyanarayana  
Vratam

Every Last  
Saturday 6:30 pm  
Ayyappa Padi Pooja



# SAI TEMPLE MALVERN



# FEBRUARY 2026



170 Planebrook Rd, Malvern, PA 19355  
Tel : 610-296-2039, 510-644-2596  
www.saitemplemalvern.com  
info@saitemplepa.com

VISVAVASU, AYANA : UTTARA, RITU : SHISHIRA, MAGHA – PHALGUNA, MAKARA-KUMBHA, THAI-MASI

## SUN (BHANU) MON (INDU) TUE (BHAUMA) WED (SAUMYA) THU (BRUHASPATHI) FRI (BHRUGU) SAT (STHIRA)

<b>1</b> T: PURNIMA 17:08 N: PUSHYA 13:28 VA: 25:38+27:09+ RK: 16:05-17:21 YG: 12:16-13:32 SR: 07:10 SS: 17:21	<b>2</b> T: PRATIPADA 15:22 N: ASHLESHA 12:17 VA: 23:59-25:32+ RK: 08:26-09:43 YG: 10:59-12:16 SR: 07:10 SS: 17:22	<b>3</b> T: DWITIYA 14:10 N: MAGHA 11:40 VA: 19:41-21:17 RK: 14:50-16:07 YG: 09:42-10:59 SR: 07:09 SS: 17:24	<b>4</b> T: TRITIYA 13:39 N: P.PHALGUNI 11:42 VA: 19:08-20:47 RK: 12:16-13:33 YG: 08:25-09:42 SR: 07:08 SS: 17:25	<b>5</b> T: CHATURTHI 13:52 N: U.PHALGUNI 12:27 VA: 21:21-23:03 RK: 13:34-14:51 YG: 07:07-08:24 SR: 07:07 SS: 17:26	<b>6</b> T: PANCHAMI 14:48 N: HASTA 13:53 VA: 22:35-24:19+ RK: 10:59-12:16 YG: 14:52-16:10 SR: 07:05 SS: 17:27	<b>7</b> T: SHASHTHI 16:24 N: CHITRA 15:58 VA: 22:10-23:56 RK: 09:40-10:58 YG: 13:34-14:52 SR: 07:04 SS: 17:28
<b>8</b> T: SAPTAMI 18:31 N: SWATI 18:32 VA: 24:49+26:36+ RK: 16:11-17:30 YG: 12:16-13:35 SR: 07:03 SS: 17:30	<b>9</b> T: ASHTAMI 20:57 N: VISHAKHA 21:25 VA: 25:55+27:42+ RK: 08:21-09:39 YG: 10:58-12:17 SR: 07:02 SS: 17:31	<b>10</b> T: NAVAMI 23:28 N: ANURADHA 24:23+ VA: 30:38+08:25 on 11 <sup>th</sup> RK: 14:54-16:13 YG: 09:39-10:58 SR: 07:01 SS: 17:32	<b>11</b> T: DASHAMI 25:52+ N: JYESHTHA 27:12+ VA: 12:17-13:36 RK: 08:19-09:38 YG: 07:00 SS: 17:33	<b>12</b> T: EKADASHI 27:55+ N: MULA 29:42+ VA: 12:02-13:48 RK: 13:36-14:56 YG: 06:59-08:18 SR: 06:59 SS: 17:34	<b>13</b> T: DWADASHI 29:31+ N: P.ASHADHA FULL NIGHT VA: 16:08-17:52 RK: 10:57-12:17 YG: 14:56-16:16 SR: 06:57 SS: 17:36	<b>14</b> T: TRAYODASHI 30:34+ N: P.ASHADHA 07:46 VA: 16:17-17:59 RK: 09:36-10:56 YG: 13:37-14:57 SR: 06:56 SS: 17:37
<b>15</b> T: CHATURDASHI FULL NIGHT N: U.ASHADHA 09:18 VA: 13:28-15:08 RK: 16:18-17:38 YG: 12:16-13:37 SR: 06:55 SS: 17:38	<b>16</b> T: CHATURDASHI 07:04 N: SHRAVANA 10:17 VA: 14:22-16:00 RK: 08:14-09:35 YG: 10:56-12:16 SR: 06:54 SS: 17:39	<b>17</b> T: AMAVASYA 07:00 T: PRATIPADA 30:27+ N: DHANISHTHA 10:46 VA: 17:58-19:34 RK: 14:58-16:19 YG: 09:34-10:55 SR: 06:52 SS: 17:40	<b>18</b> T: DWITIYA 29:28+ N: SHATABHISHA 10:46 VA: 17:03-18:38 RK: 13:38-14:59 YG: 08:12-09:34 SR: 06:51 SS: 17:42	<b>19</b> T: TRITIYA 28:08+ N: P.BHADRAPADA 10:22 VA: 19:40-21:13 RK: 13:38-14:59 YG: 06:50-08:11 SR: 06:50 SS: 17:43	<b>20</b> T: CHATURTHI 26:30+ N: U.BHADRAPADA 09:37 VA: 21:07-22:39 RK: 10:54-12:16 YG: 15:00-16:22 SR: 06:48 SS: 17:44	<b>21</b> T: PANCHAMI 24:39+ N: REVATI 08:37 VA: 27:36+29:07+ RK: 09:31-10:54 YG: 13:38-15:00 SR: 06:47 SS: 17:45
<b>22</b> T: SHASHTHI 22:39 N: ASHWINI 07:24 N: BHARANI 30:03+ VA: 16:28-17:58 RK: 16:24-17:46 YG: 12:16-13:38 SR: 06:45 SS: 17:46	<b>23</b> T: SAPTAMI 20:31 N: KRITTIKA 28:37+ VA: 17:20-18:50 RK: 08:07-09:30 YG: 10:53-12:16 SR: 06:44 SS: 17:47	<b>24</b> T: ASHTAMI 18:21 N: ROHINI 27:08+ VA: 19:38-21:08 RK: 15:02-16:25 YG: 09:29-10:52 SR: 06:43 SS: 17:48	<b>25</b> T: NAVAMI 16:10 N: MRIGASHIRA 25:41+ VA: 08:24-09:54 RK: 12:15-13:39 YG: 08:05-09:28 SR: 06:41 SS: 17:50	<b>26</b> T: DASHAMI 14:03 N: ARDRA 24:18+ VA: 09:36-11:07 RK: 13:39-15:03 YG: 06:40-08:04 SR: 06:40 SS: 17:51	<b>27</b> T: EKADASHI 12:02 N: PUNARVASU 23:05 VA: 11:42-13:13 RK: 10:51-12:15 YG: 15:03-16:28 SR: 06:38 SS: 17:52	<b>28</b> T: DWADASHI 10:13 N: PUSHYA 22:04 VA: 06:44-08:16 RK: 09:26-10:50 YG: 13:39-15:04 SR: 06:37 SS: 17:53

<b>FESTIVALS</b>	15 MAHA SHIVARATRI
01 PURNIMA VRATAM	MASA SHIVARATRI
04 SANKATAHARA CHATURTHI	22 SKANDA SASHTI
12 KUMBHA SANKRANTI	27 AMALAKI EKADASHI
VIJAYA EKADASHI	28 SHANI TRAYODASHI
14 SHANI TRAYODASHI	PRADOSHA VRATAM
PRADOSHA VRATAM	

17TH FEBRUARY 2026  
**SOLAR ECLIPSE**  
ECLIPSE WOULD NOT BE  
VISIBLE IN MALVERN

PANCHANGA BY DR. MURALI BHUVANAGIRI CALCULATED AS PER MALVERN, PA, USA'S LONGITUDE & LATITUDE, WHEN TITHI OR NAKSHATRA ENDS PAST MIDNIGHT "MON/DATE" IS INDICATED AS HINDU DAY IS FROM ONE SUNRISE TO ANOTHER SUNRISE. TITHI, NAKSHATRA TIMINGS ARE END TIMES, WHEN ONE ENDS ANOTHER BEGINS. '+' SYMBOL INDICATES NEXT DAY

**THE MORTGAGEIST**  
YOUR MORTGAGE SPECIALIST

**Apeksha Sista** NMLS# 2692605  
**(610) 836-2332**

**Kumar Sista** NMLS# 2369551  
**(610) 618-0618**

Your Very Own Loan Officer

The Mortgageist, NMLS# 2710734, 150 Allendale Rd, Ste. 2200, King of Prussia, PA 19406

**EXPERIOR**  
FINANCIAL GROUP, INC

**Srikanth Katupilla**  
724 689 7999  
skatupilla@experiorfincialgroup.com

**Ashish Joshi**  
717 395 6154  
ajoshi@experiorfincialgroup.com

- College Saving Plans
- Tax Saving Plans
- Mortgage Protection
- Retirement Strategies
- Business Coaching & Mentoring

Estate Planning / Will and Trust  
Credit Score Fix Services  
Wealth building, protection & recovery  
Legal Protection Services  
Life Insurance & Long term Care

# Real Estate Your Way

I Speak Tamil, Hindi and English



**Bagya Iyer, ABR<sup>®</sup>, SRS<sup>®</sup>, Realtor<sup>®</sup>**  
Licensed in PA, DE and NJ  
**Cell: 484-364-1955**

- **Buying | Selling**
- **Investment**
- **Commercial**

**RE/MAX Action Associates - PA and DE**  
**RE/MAX Surfside - NJ**

**610-363-2001 | 609-884-4242**



# SAI TEMPLE MALVERN



# MARCH 2026



170 Planebrook Rd, Malvern, PA 19355  
Tel : 610-296-2039, 510-644-2596  
www.saitemplemalvern.com  
info@saitemplepa.com

VISVAVASU – PARABHAVA, AYANA : UTTARA, RITU : SHISHIRA-VASANTA, PHALGUNA – PARABHAVA CHAITRA, KUMBHA-MINA, MASI-PANGUNI

## SUN (BHANU) MON (INDU) TUE (BHAUMA) WED (SAUMYA) THU (BRUHASPATHI) FRI (BHRUGU) SAT (STHIRA)

<b>1</b> T: TRAYODASHI 08:39 N: ASHLESHA 21:21 RK: 16:29-17:54 YG: 12:15-13:40 VA: 10:29-12:02 SR: 06:35 SS: 17:54	<b>2</b> T: CHATURDASHI 07:25 N: MAGHA 21:01 VA: 09:11-10:46 VA: 29:04+06:40 on 3 <sup>rd</sup> RK: 07:59-09:24 YG: 10:49-12:14 SR: 06:34 SS: 17:55	<b>3</b> T: PURNIMA 06:37 T: PRATIPADA 30:18+ N: P.PHALGUNI 21:09 VA: 28:32+30:11+ RK: 15:05-16:31 YG: 09:23-10:49 SR: 06:32 SS: 17:56	<b>4</b> T: DWITIYA FULL NIGHT N: U.PHALGUNI 21:47 RK: 12:14-13:40 YG: 07:57-09:22 SR: 06:31 SS: 17:57	<b>5</b> T: DWITIYA 06:33 N: HASTA 22:59 VA: 06:37-08:17 RK: 13:40-15:06 YG: 06:29-07:55 SR: 06:29 SS: 17:58	<b>6</b> T: TRITIYA 07:23 N: CHITRA 24:45+ VA: 07:35-09:18 RK: 10:47-12:14 YG: 15:07-16:33 SR: 06:28 SS: 17:59	<b>7</b> T: CHATURTHI 08:47 N: SWATI 28:01+ VA: 06:53-08:38 RK: 09:20-10:47 YG: 13:40-15:07 SR: 06:26 SS: 18:01		
<b>8</b> T: PANCHAMI 11:40 N: VISHAKHA 30:41+ VA: 10:15-12:01 RK: 17:35-19:02 YG: 13:13-14:40 SR: 07:25 SS: 19:02	<b>9</b> T: SHASHTHI 13:57 N: ANURADHA FULL NIGHT VA: 11:10-12:58 RK: 08:50-10:18 YG: 11:45-13:13 SR: 07:23 SS: 19:03	<b>10</b> T: SAPTAMI 16:24 N: ANURADHA 09:35 VA: 15:52-17:39 RK: 16:08-17:36 YG: 10:17-11:45 SR: 07:21 SS: 19:04	<b>11</b> T: ASHTAMI 18:49 N: JYESHTHA 12:30 VA: 21:24-23:11 RK: 13:12-14:40 YG: 08:48-10:16 SR: 07:20 SS: 19:05	<b>12</b> T: NAVAMI 20:58 N: MULA 15:13 VA: 13:26-15:13 VA: 25:45+27:30+ RK: 14:41-16:09 YG: 07:18-08:47 SR: 07:18 SS: 19:06	<b>13</b> T: DASHAMI 22:40 N: P.ASHADHA 17:33 VA: 26:08+27:51+ RK: 11:43-13:12 YG: 16:09-17:38 SR: 07:17 SS: 19:07	<b>14</b> T: EKADASHI 23:46 N: U.ASHADHA 19:19 VA: 23:30-25:10+ RK: 10:13-11:42 YG: 14:41-16:10 SR: 07:15 SS: 19:08		
<b>15</b> T: DWADASHI 24:10+ N: SHRAVANA 20:26 VA: 24:30+26:08+ RK: 17:40-19:09 YG: 13:11-14:41 SR: 07:13 SS: 19:09	<b>16</b> T: TRAYODASHI 23:53 N: DHANISHTHA 20:52 VA: 28:00+29:35+ RK: 08:42-10:11 YG: 11:41-13:11 SR: 07:12 SS: 19:10	<b>17</b> T: CHATURDASHI 22:55 N: SHATABHISHA 20:39 VA: 26:50+28:23+ RK: 16:11-17:41 YG: 10:10-11:41 SR: 07:10 SS: 19:11	<b>18</b> T: AMAVASYA 21:22 N: P.BHADRAPADA 19:51 VA: 28:56+30:27+ RK: 13:10-14:41 YG: 08:39-10:10 SR: 07:09 SS: 19:12	<b>19</b> T: PRATIPADA 19:22 N: U.BHADRAPADA 18:35 VA: 29:46+07:16 on 20 <sup>th</sup> RK: 14:41-16:12 YG: 07:07-08:38 SR: 07:07 SS: 19:13	<b>20</b> T: DWITIYA 17:00 N: REVATI 16:57 RK: 11:39-13:10 YG: 16:12-17:43 SR: 07:05 SS: 19:14	<b>21</b> T: TRITIYA 14:26 N: ASHWINI 15:07 VA: 11:26-12:54 VA: 23:57-25:26+ RK: 10:07-11:38 YG: 14:41-16:12 SR: 07:04 SS: 19:15		
<b>22</b> T: CHATURTHI 11:46 N: BHARANI 13:12 VA: 24:16+25:44+ RK: 17:45-19:16 YG: 13:09-14:41 SR: 07:02 SS: 19:16	<b>23</b> T: PANCHAMI 09:08 T: SHASHTHI 30:37+ N: KRITTIKA 11:19 VA: 26:09+27:38+ RK: 08:33-10:05 YG: 11:37-13:09 SR: 07:01 SS: 19:17	<b>24</b> T: SAPTAMI 28:20+ N: ROHINI 09:34 VA: 14:49-16:19 RK: 16:13-17:46 YG: 10:04-11:36 SR: 06:59 SS: 19:18	<b>25</b> T: ASHTAMI 26:18+ N: MRIGASHIRA 08:03 N: ARDRA 30:49+ VA: 16:01-17:32 RK: 13:08-14:41 YG: 08:30-10:03 SR: 06:57 SS: 19:19	<b>26</b> T: NAVAMI 24:36+ N: PUNARVASU 29:54+ VA: 18:21-19:54 RK: 14:41-16:14 YG: 06:56-08:29 SR: 06:56 SS: 19:20	<b>27</b> T: DASHAMI 23:15 N: PUSHYA 29:20+ VA: 13:42-15:16 RK: 11:34-13:08 YG: 16:15-17:48 SR: 06:54 SS: 19:21	<b>28</b> T: EKADASHI 22:16 N: ASHLESHA 29:08+ VA: 18:01-19:36 RK: 10:00-11:34 YG: 14:41-16:15 SR: 06:52 SS: 19:22		
<b>29</b> T: DWADASHI 21:39 N: MAGHA 29:18+ VA: 17:13-18:49 RK: 17:49-19:23 YG: 13:07-14:41 SR: 06:51 SS: 19:23	<b>30</b> T: TRAYODASHI 21:25 N: P.PHALGUNI 29:50+ VA: 13:29-15:07 RK: 08:24-09:58 YG: 11:32-13:07 SR: 06:49 SS: 19:24	<b>31</b> T: CHATURDASHI 21:36 N: U.PHALGUNI FULL NIGHT VA: 13:19-14:59 RK: 16:16-17:51 YG: 09:57-11:32 SR: 06:48 SS: 19:25	<b>FESTIVALS</b> 02 CHHOTI HOLI HOLIKA DAHAN PURNIMA VRATAM 03 HOLI 06 SANKATAHARA CHATURTHI			08 INTERNATIONAL WOMEN'S DAY 14 MEENA SANKRANTI PAPAMOCHANI EKADASHI 16 PRADOSHA VRATAM MASA SHIVARATRI 19 UGADI, GUDI PADWA 21 MATSYA JAYANTI		22 LAKSHMI PANCHAMI 23 SKANDA SASHTI 26 SRI RAMA NAVAMI 28 KAMADA EKADASHI 29 VAMANA DWADASHI 30 PRADOSHA VRATAM

3<sup>rd</sup> MARCH 2026  
**TOTAL LUNAR ECLIPSE IN IRVING MALVERN**  
STARTS - 04:51 AM.  
ENDS - 06:30 AM  
DURATION - 01 HOUR 38 MINS 38 SECS

PANCHANGA BY DR. MURALI BHUVANAGIRI CALCULATED AS PER MALVERN, PA, USA'S LONGITUDE & LATITUDE, WHEN TITHI OR NAKSHATRA ENDS PAST MIDNIGHT "MON/DATE" IS INDICATED AS HINDU DAY IS FROM ONE SUNRISE TO ANOTHER SUNRISE. TITHI, NAKSHATRA TIMINGS ARE END TIMES, WHEN ONE ENDS ANOTHER BEGINS. '+' SYMBOL INDICATES NEXT DAY

**THE MORTGAGEIST**  
YOUR MORTGAGE SPECIALIST

**Apeksha Sista** NMLS# 2692605  
**(610) 836-2332**

**Kumar Sista** NMLS# 2369551  
**(610) 618-0618**

Your Very Own Loan Officer

The Mortgageist, NMLS# 2710734, 150 Allendale Rd, Ste. 2200, King of Prussia, PA 19406

**EXPERIOR**  
FINANCIAL GROUP, INC

**Srikanth Katupilla**  
724 689 7999  
skatupilla@experiorfinancialgroup.com

**Ashish Joshi**  
717 395 6154  
ajoshi@experiorfinancialgroup.com

- College Saving Plans
- Tax Saving Plans
- Mortgage Protection
- Retirement Strategies
- Business Coaching & Mentoring

Estate Planning / Will and Trust  
Credit Score Fix Services  
Wealth building, protection & recovery  
Legal Protection Services  
Life Insurance & Long term Care

Every  
Monday 6:30 pm  
Shiva Abhishekam

Every  
Thursday 10:30 am  
Baba Abhishekam

Every  
2nd Tuesday 6:30 pm  
Muragan Abhishekam

Every  
1st Friday 6:30 pm  
Sri Chakra Abhishekam

Every  
Saturday 10:30 am  
Balaji Abhishekam



Every  
Sankatahara  
Chaturthi 6:30 pm  
Ganapathi  
Abhishekam

Every  
Full Moon day  
Group  
Satyanarayana  
Vratam

Every Last  
Saturday 6:30 pm  
Ayyappa Padi Pooja



# SAI TEMPLE MALVERN



# APRIL 2026



170 Planebrook Rd, Malvern, PA 19355  
Tel : 610-296-2039, 510-644-2596  
www.saitemplemalvern.com  
info@saitemplepa.com

PARABHAVA, AYANA : UTTARA, RITU : VASANTA-GRISHMA, CHAITRA - VAISHAKHA, MINA-MESHA, PANGUNI-CHITTIRAI

## SUN (BHANU) MON (INDU) TUE (BHAUMA) WED (SAUMYA) THU (BRUHASPATHI) FRI (BHRUGU) SAT (STHIRA)

SUN (BHANU)	MON (INDU)	TUE (BHAUMA)	WED (SAUMYA)	THU (BRUHASPATHI)	FRI (BHRUGU)	SAT (STHIRA)
<b>FESTIVALS</b> 01 PURNIMA VRATAM 05 SANKATAHARA CHATURTHI 13 MESHA SANKRANTI VARUTHINI EKADASHI 14 PRADOSHA VRATAM	15 MASA SHIVARATRI 19 PARASHURAMA JAYANTI AKSHAYA TRITIYA 21 SHANKARACHARYA JAYANTI SKANDA SASHTI 22 RAMANUJA JAYANTI	26 MOHINI EKADASHI 27 PARASHURAMA DWADASHI 28 PRADOSHA VRATAM 29 NARASIMHA JAYANTI 30 KURMA JAYANTI PURNIMA VRATAM	<b>1</b> T: PURNIMA 22:11 N: U.PHALGUNI 06:47 VA: 15:40-17:21 RK: 13:06-14:41 YG: 08:21-09:56 SR: 06:46 SS: 19:27	<b>2</b> T: PRATIPADA 23:12 N: HASTA 08:08 VA: 16:44-18:27 RK: 14:41-16:17 YG: 06:44-08:20 SR: 06:44 SS: 19:28	<b>3</b> T: DWITIYA 24:38+ N: CHITRA 09:55 VA: 16:01-17:46 RK: 11:30-13:06 YG: 16:17-17:53 SR: 06:43 SS: 19:29	<b>4</b> T: TRITIYA 26:29+ N: SWATI 12:05 VA: 18:17-20:03 RK: 09:53-11:29 YG: 14:41-16:17 SR: 06:41 SS: 19:30
<b>5</b> T: CHATURTHI 28:40+ N: VISHAKHA 14:38 VA: 19:06-20:53 RK: 17:54-19:31 YG: 13:05-14:41 SR: 06:40 SS: 19:31	<b>6</b> T: PANCHAMI FULL NIGHT N: ANURADHA 17:27 VA: 23:44-25:32+ RK: 08:15-09:51 YG: 11:28-13:05 SR: 06:38 SS: 19:32	<b>7</b> T: PANCHAMI 07:04 N: JYESHTHA 20:24 VA: 29:22+07:10 on 8 <sup>th</sup> RK: 16:19-17:56 YG: 09:50-11:27 SR: 06:36 SS: 19:33	<b>8</b> T: SHASHTHI 09:31 N: MULA 23:18 VA: 21:31-23:18 RK: 13:04-14:42 YG: 08:12-09:50 SR: 06:35 SS: 19:34	<b>9</b> T: SAPTAMI 11:49 N: P.ASHADHA 25:58+ VA: 09:58-11:45 RK: 14:42-16:19 YG: 06:33-08:11 SR: 06:33 SS: 19:35	<b>10</b> T: ASHTAMI 13:45 N: U.ASHADHA 28:09+ VA: 10:42-12:26 RK: 11:26-13:04 YG: 16:20-17:58 SR: 06:32 SS: 19:36	<b>11</b> T: NAVAMI 15:07 N: SHRAVANA 29:44+ VA: 08:25-10:07 RK: 09:47-11:25 YG: 14:42-16:20 SR: 06:30 SS: 19:37
<b>12</b> T: DASHAMI 15:46 N: DHANISHTHA FULL NIGHT VA: 09:52-11:31 RK: 17:59-19:38 YG: 13:03-14:42 SR: 06:29 SS: 19:38	<b>13</b> T: EKADASHI 15:38 N: DHANISHTHA 06:33 VA: 13:46-15:22 RK: 08:06-09:45 YG: 11:24-13:03 SR: 06:27 SS: 19:39	<b>14</b> T: DWADASHI 14:42 N: SHATABHISHA 06:36 N: P.BHADRAPADA 29:52+ VA: 12:48-14:21 RK: 16:21-18:00 YG: 09:44-11:23 SR: 06:26 SS: 19:40	<b>15</b> T: TRAYODASHI 13:01 N: U.BHADRAPADA 28:29+ VA: 14:55-16:25 RK: 13:02-14:42 YG: 08:04-09:43 SR: 06:24 SS: 19:41	<b>16</b> T: CHATURDASHI 10:41 N: REVATI 26:32+ VA: 15:30-16:59 RK: 14:42-16:22 YG: 06:23-08:03 SR: 06:23 SS: 19:42	<b>17</b> T: AMAVASYA 07:51 T: PRATIPADA 28:40+ N: ASHWINI 24:12+ VA: 20:36-22:02 RK: 11:22-13:02 YG: 16:22-18:03 SR: 06:21 SS: 19:43	<b>18</b> T: DWITIYA 25:19+ N: BHARANI 21:40 VA: 08:47-10:13 RK: 09:41-11:21 YG: 14:42-16:23 SR: 06:20 SS: 19:44
<b>19</b> T: TRITIYA 21:57 N: KRITTIKA 19:05 VA: 08:22-09:48 RK: 18:04-19:45 YG: 13:02-14:42 SR: 06:18 SS: 19:45	<b>20</b> T: CHATURTHI 18:44 N: ROHINI 16:38 VA: 09:27-10:53 VA: 21:44-23:11 RK: 07:58-09:39 YG: 11:20-13:01 SR: 06:17 SS: 19:46	<b>21</b> T: PANCHAMI 15:49 N: MRIGASHIRA 14:28 VA: 22:15-23:44 RK: 16:24-18:05 YG: 09:38-11:20 SR: 06:15 SS: 19:47	<b>22</b> T: SHASHTHI 13:19 N: ARDRA 12:43 VA: 24:05+25:36+ RK: 13:01-14:43 YG: 07:56-09:37 SR: 06:14 SS: 19:48	<b>23</b> T: SAPTAMI 11:19 N: PUNARVASU 11:27 VA: 19:13-20:46 RK: 14:43-16:25 YG: 06:13-07:55 SR: 06:13 SS: 19:49	<b>24</b> T: ASHTAMI 09:51 N: PUSHYA 10:44 VA: 23:27-25:02+ RK: 11:18-13:01 YG: 16:25-18:08 SR: 06:11 SS: 19:50	<b>25</b> T: NAVAMI 08:57 N: ASHLESHA 10:34 VA: 22:46-24:23+ RK: 09:35-11:18 YG: 14:43-16:26 SR: 06:10 SS: 19:51
<b>26</b> T: DASHAMI 08:36 N: MAGHA 10:57 VA: 19:14-20:53 RK: 18:09-19:52 YG: 13:00-14:43 SR: 06:08 SS: 19:52	<b>27</b> T: EKADASHI 08:45 N: P.PHALGUNI 11:48 VA: 19:24-21:05 RK: 07:50-09:34 YG: 11:17-13:00 SR: 06:07 SS: 19:53	<b>28</b> T: DWADASHI 09:21 N: U.PHALGUNI 13:06 VA: 22:05-23:48 RK: 16:27-18:10 YG: 09:33-11:16 SR: 06:06 SS: 19:54	<b>29</b> T: TRAYODASHI 10:21 N: HASTA 14:46 VA: 23:26-25:10+ RK: 13:00-14:44 YG: 07:48-09:32 SR: 06:05 SS: 19:55	<b>30</b> T: CHATURDASHI 11:42 N: CHITRA 16:46 VA: 22:55-24:40+ RK: 14:44-16:28 YG: 06:03-07:47 SR: 06:03 SS: 19:56		

PANCHANGA BY DR. MURALI BHUVANAGIRI CALCULATED AS PER MALVERN, PA, USA'S LONGITUDE & LATITUDE, WHEN TITHI OR NAKSHATRA ENDS PAST MIDNIGHT "MON/DATE" IS INDICATED AS HINDU DAY IS FROM ONE SUNRISE TO ANOTHER SUNRISE. TITHI, NAKSHATRA TIMINGS ARE END TIMES, WHEN ONE ENDS ANOTHER BEGINS. '+' SYMBOL INDICATES NEXT DAY

**THE MORTGAGEIST**  
YOUR MORTGAGE SPECIALIST

**Apeksha Sista** NMLS# 2692605  
**(610) 836-2332**

**Kumar Sista** NMLS# 2369551  
**(610) 618-0618**

**Your Very Own Loan Officer**

The Mortgageist, NMLS# 2710734, 150 Allendale Rd, Ste. 2200, King of Prussia, PA 19406

**EXPERIOR**  
FINANCIAL GROUP, INC

**Srikanth Katupilla**  
724 689 7999  
skatupilla@experiorfinancialgroup.com

**Ashish Joshi**  
717 395 6154  
ajoshi@experiorfinancialgroup.com

- College Saving Plans
- Tax Saving Plans
- Mortgage Protection
- Retirement Strategies
- Business Coaching & Mentoring

Estate Planning / Will and Trust  
Credit Score Fix Services  
Wealth building, protection & recovery  
Legal Protection Services  
Life Insurance & Long term Care

# LS Property Investments

Offering Partnership Opportunities to own Landmark Shopping Centers!



**Suresh Kagithapu**

CEO, LS Property Investments  
 Email: Suresh@LSPropertyInvestments.com  
 Phone: (610) 871 2332

Looking for exclusive real estate investments offering outstanding returns and powerful tax benefits?

Explore exclusive commercial real estate partnership opportunities from a trusted syndication firm empowered with over 16 years of successful track record in acquiring and managing prestigious neighborhood shopping centers.



Your gateway to becoming a proud co-landlord of landmark shopping centers!

## Key Equity Investment Partners



Amar Varada



Srinivas Adda



Harish Koya



Siva Pola



Radha Alla



Sitaram Mulkamala



Venkata Kalidindi



Rajaram Katragadda



Chandrasekhar Kunavarapu



Chatarzy Kaza



Harinath Bungatavula



Ravi Musuku



Mallikarjun Bolla



Naga Goli



Giri Mannepli



Anand Solanki



Sai Krishna Pola



Srikrishna Vishnuvajhala



Chandra Jalluri



Viswa Kandi

### Portfolio Properties



Dorneyville Plaza



The Shops on Eagleview Blvd



Sinking Spring Shopping Center



Bensalem Square Shopping Center



Darby Town Center



Cherry Square Shopping Center



New Garden Center



Stowe Crossing Shopping Center



# SAI TEMPLE MALVERN



# MAY 2026



170 Planebrook Rd, Malvern, PA 19355  
 Tel : 610-296-2039, 510-644-2596  
[www.saitemplemalvern.com](http://www.saitemplemalvern.com)  
[info@saitemplepa.com](mailto:info@saitemplepa.com)

PARABHAVA, AYANA : UTTARA, RITU : GRISHMA, VAISAKHA – ADHIKA JYESTHA, MESHA-VRISHABHA, CHITTIRAI - VAIKASI

## SUN (BHANU) MON (INDU) TUE (BHAUMA) WED (SAUMYA) THU (BRUHASPATHI) FRI (BHRUGU) SAT (STHIRA)

<b>31</b> <b>T:</b> PRATIPADA FULL NIGHT <b>N:</b> ANURADHA 06:42 <b>VA:</b> 12:59-14:47 <b>RK:</b> 18:33-20:24 <b>YG:</b> 13:00-14:51 <b>SR:</b> 05:36 <b>SS:</b> 20:24	<b>FESTIVALS</b> 04 SANKATAHARA CHATURTHI 10 MOTHER'S DAY 11 HANUMAN JAYANTI 12 APARA EKADASHI 14 VRISHABHA SANKRANTI PRADOSHA VRATAM	14 MASA SHIVARATRI 16 VAT SAVITRI VRATAM SHANI JAYANTI 21 SKANDA SASHTI 26 PADMINI EKADASHI 28 PRADOSHA VRATAM 30 PURNIMA VRATAM			<b>1</b> <b>T:</b> PURNIMA 13:22 <b>N:</b> SWATI 19:05 <b>VA:</b> 25:17+27:03+ <b>RK:</b> 11:15-12:59 <b>YG:</b> 16:28-18:13 <b>SR:</b> 06:02 <b>SS:</b> 19:57	<b>2</b> <b>T:</b> PRATIPADA 15:19 <b>N:</b> VISHAKHA 21:40 <b>VA:</b> 26:08+27:55+ <b>RK:</b> 09:30-11:15 <b>YG:</b> 14:44-16:29 <b>SR:</b> 06:01 <b>SS:</b> 19:58
<b>3</b> <b>T:</b> DWITIYA 17:31 <b>N:</b> ANURADHA 24:28+ <b>RK:</b> 18:14-19:59 <b>YG:</b> 12:59-14:44 <b>SR:</b> 06:00 <b>SS:</b> 19:59	<b>4</b> <b>T:</b> TRITIYA 19:54 <b>N:</b> JYESTHA 27:25+ <b>VA:</b> 06:45-08:33 <b>RK:</b> 07:44-09:29 <b>YG:</b> 11:14-12:59 <b>SR:</b> 05:58 <b>SS:</b> 20:00	<b>5</b> <b>T:</b> CHATURTHI 22:21 <b>N:</b> MULA FULL NIGHT <b>VA:</b> 12:24-14:12 <b>VA:</b> 28:36+06:24 on 6 <sup>th</sup> <b>RK:</b> 16:30-18:16 <b>YG:</b> 09:28-11:14 <b>SR:</b> 05:57 <b>SS:</b> 20:01	<b>6</b> <b>T:</b> PANCHAMI 24:43+ <b>N:</b> MULA 06:24 <b>VA:</b> 17:08-18:56 <b>RK:</b> 12:59-14:45 <b>YG:</b> 07:42-09:28 <b>SR:</b> 05:56 <b>SS:</b> 20:02	<b>7</b> <b>T:</b> SHASHTHI 26:51+ <b>N:</b> P.ASHADHA 09:16 <b>VA:</b> 18:07-19:53 <b>RK:</b> 14:45-16:31 <b>YG:</b> 05:55-07:41 <b>SR:</b> 05:55 <b>SS:</b> 20:03	<b>8</b> <b>T:</b> SAPTAMI 28:32+ <b>N:</b> U.ASHADHA 11:50 <b>VA:</b> 16:10-17:55 <b>RK:</b> 11:13-12:59 <b>YG:</b> 16:31-18:18 <b>SR:</b> 05:54 <b>SS:</b> 20:04	<b>9</b> <b>T:</b> ASHTAMI 29:36+ <b>N:</b> SHRAVANA 13:54 <b>VA:</b> 18:09-19:50 <b>RK:</b> 09:26-11:12 <b>YG:</b> 14:45-16:32 <b>SR:</b> 05:53 <b>SS:</b> 20:05
<b>10</b> <b>T:</b> NAVAMI FULL NIGHT <b>N:</b> DHANISHTHA 15:20 <b>VA:</b> 22:43-24:22+ <b>RK:</b> 18:19-20:06 <b>YG:</b> 12:59-14:46 <b>SR:</b> 05:52 <b>SS:</b> 20:06	<b>11</b> <b>T:</b> NAVAMI 05:54 <b>T:</b> DASHAMI 29:22+ <b>N:</b> SHATABHISHA 15:58 <b>VA:</b> 22:19-23:55 <b>RK:</b> 07:38-09:25 <b>YG:</b> 11:12-12:59 <b>SR:</b> 05:51 <b>SS:</b> 20:07	<b>12</b> <b>T:</b> EKADASHI 27:59+ <b>N:</b> P.BHADRAPADA 15:47 <b>VA:</b> 24:59+26:31+ <b>RK:</b> 16:33-18:21 <b>YG:</b> 09:24-11:11 <b>SR:</b> 05:50 <b>SS:</b> 20:08	<b>13</b> <b>T:</b> DWADASHI 25:50+ <b>N:</b> U.BHADRAPADA 14:47 <b>VA:</b> 25:55+27:24+ <b>RK:</b> 12:59-14:46 <b>YG:</b> 07:36-09:24 <b>SR:</b> 05:49 <b>SS:</b> 20:09	<b>14</b> <b>T:</b> TRAYODASHI 23:01 <b>N:</b> REVATI 13:04 <b>VA:</b> 14:46-16:34 <b>YG:</b> 05:48-07:35 <b>SR:</b> 05:48 <b>SS:</b> 20:10	<b>15</b> <b>T:</b> CHATURDASHI 19:41 <b>N:</b> ASHWINI 10:44 <b>VA:</b> 07:08-08:34 <b>VA:</b> 19:15-20:40 <b>RK:</b> 11:11-12:59 <b>YG:</b> 16:35-18:23 <b>SR:</b> 05:47 <b>SS:</b> 20:11	<b>16</b> <b>T:</b> AMAVASYA 16:00 <b>N:</b> BHARANI 08:00 <b>N:</b> KRITTIKA 29:02+ <b>VA:</b> 18:31-19:55 <b>RK:</b> 09:22-11:10 <b>YG:</b> 14:47-16:35 <b>SR:</b> 05:46 <b>SS:</b> 20:12
<b>17</b> <b>T:</b> PRATIPADA 12:10 <b>N:</b> ROHINI 26:02+ <b>VA:</b> 19:02-20:26 <b>RK:</b> 18:24-20:13 <b>YG:</b> 12:59-14:47 <b>SR:</b> 05:45 <b>SS:</b> 20:13	<b>18</b> <b>T:</b> DWITIYA 08:23 <b>T:</b> TRITIYA 28:48+ <b>N:</b> MRIGASHIRA 23:11 <b>VA:</b> 06:58-08:23 <b>RK:</b> 07:33-09:21 <b>YG:</b> 11:10-12:59 <b>SR:</b> 05:44 <b>SS:</b> 20:14	<b>19</b> <b>T:</b> CHATURTHI 25:36+ <b>N:</b> ARDRA 20:42 <b>VA:</b> 06:43-08:09 <b>RK:</b> 16:37-18:26 <b>YG:</b> 09:21-11:10 <b>SR:</b> 05:43 <b>SS:</b> 20:14	<b>20</b> <b>T:</b> PANCHAMI 22:56 <b>N:</b> PUNARVASU 18:42 <b>VA:</b> 07:42-09:10 <b>VA:</b> 26:14+27:45+ <b>RK:</b> 12:59-14:48 <b>YG:</b> 07:32-09:21 <b>SR:</b> 05:42 <b>SS:</b> 20:15	<b>21</b> <b>T:</b> SHASHTHI 20:54 <b>N:</b> PUSHYA 17:19 <b>RK:</b> 14:48-16:38 <b>YG:</b> 05:42-07:31 <b>SR:</b> 05:42 <b>SS:</b> 20:16	<b>22</b> <b>T:</b> SAPTAMI 19:34 <b>N:</b> ASHLESHA 16:38 <b>VA:</b> 05:45-07:18 <b>VA:</b> 28:38+06:14 on 23 <sup>rd</sup> <b>RK:</b> 11:09-12:59 <b>YG:</b> 16:38-18:28 <b>SR:</b> 05:41 <b>SS:</b> 20:17	<b>23</b> <b>T:</b> ASHTAMI 18:57 <b>N:</b> MAGHA 16:39 <b>VA:</b> 24:53+26:32+ <b>RK:</b> 09:20-11:09 <b>YG:</b> 14:49-16:39 <b>SR:</b> 05:40 <b>SS:</b> 20:18
<b>24</b> <b>T:</b> NAVAMI 19:00 <b>N:</b> P.PHALGUNI 17:21 <b>VA:</b> 24:56+26:37+ <b>RK:</b> 18:29-20:19 <b>YG:</b> 12:59-14:49 <b>SR:</b> 05:40 <b>SS:</b> 20:19	<b>25</b> <b>T:</b> DASHAMI 19:40 <b>N:</b> U.PHALGUNI 18:38 <b>VA:</b> 27:40+29:23+ <b>RK:</b> 07:29-09:19 <b>YG:</b> 11:09-12:59 <b>SR:</b> 05:39 <b>SS:</b> 20:20	<b>26</b> <b>T:</b> EKADASHI 20:51 <b>N:</b> HASTA 20:26 <b>VA:</b> 29:10+06:55 on 27 <sup>th</sup> <b>RK:</b> 16:40-18:30 <b>YG:</b> 09:19-11:09 <b>SR:</b> 05:38 <b>SS:</b> 20:20	<b>27</b> <b>T:</b> DWADASHI 22:26 <b>N:</b> CHITRA 22:38 <b>VA:</b> 28:49+06:35 on 28 <sup>th</sup> <b>RK:</b> 12:59-14:50 <b>YG:</b> 07:28-09:19 <b>SR:</b> 05:38 <b>SS:</b> 20:21	<b>28</b> <b>T:</b> TRAYODASHI 24:20+ <b>N:</b> SWATI 25:08+ <b>RK:</b> 14:50-16:41 <b>YG:</b> 05:37-07:28 <b>SR:</b> 05:37 <b>SS:</b> 20:22	<b>29</b> <b>T:</b> CHATURDASHI 26:27+ <b>N:</b> VISHAKHA 27:50+ <b>VA:</b> 07:22-09:08 <b>RK:</b> 11:09-13:00 <b>YG:</b> 16:41-18:32 <b>SR:</b> 05:37 <b>SS:</b> 20:23	<b>30</b> <b>T:</b> PURNIMA 28:44+ <b>N:</b> ANURADHA FULL NIGHT <b>VA:</b> 08:19-10:06 <b>RK:</b> 09:18-11:09 <b>YG:</b> 14:51-16:42 <b>SR:</b> 05:36 <b>SS:</b> 20:24

PANCHANGA BY DR. MURALI BHUVANAGIRI CALCULATED AS PER MALVERN, PA, USA'S LONGITUDE & LATITUDE, WHEN TITHI OR NAKSHATRA ENDS PAST MIDNIGHT "MON/DATE" IS INDICATED AS HINDU DAY IS FROM ONE SUNRISE TO ANOTHER SUNRISE. TITHI, NAKSHATRA TIMINGS ARE END TIMES, WHEN ONE ENDS ANOTHER BEGINS. '+' SYMBOL INDICATES NEXT DAY

**THE MORTGAGEIST**  
YOUR MORTGAGE SPECIALIST

**Apeksha Sista**  
NMLS# 2692605  
**(610) 836-2332**

**Kumar Sista**  
NMLS# 2369551  
**(610) 618-0618**

**Your Very Own Loan Officer**

The Mortgageist, NMLS# 2710734, 150 Allendale Rd, Ste. 2200, King of Prussia, PA 19406

**EXPERIOR**  
FINANCIAL GROUP, INC

**Srikanth Katupilla**  
724 689 7999  
skatupilla@experiorfinancialgroup.com

**Ashish Joshi**  
717 395 6154  
ajoshi@experiorfinancialgroup.com

- College Saving Plans
- Tax Saving Plans
- Mortgage Protection
- Retirement Strategies
- Business Coaching & Mentoring

Estate Planning / Will and Trust  
Credit Score Fix Services  
Wealth building, protection & recovery  
Legal Protection Services  
Life Insurance & Long term Care

**Every**  
**Monday 6:30 pm**  
**Shiva Abhishekam**

**Every**  
**Thursday 10:30 am**  
**Baba Abhishekam**

**Every**  
**2nd Tuesday 6:30 pm**  
**Muragan Abhishekam**

**Every**  
**1st Friday 6:30 pm**  
**Sri Chakra Abhishekam**

**Every**  
**Saturday 10:30 am**  
**Balaji Abhishekam**

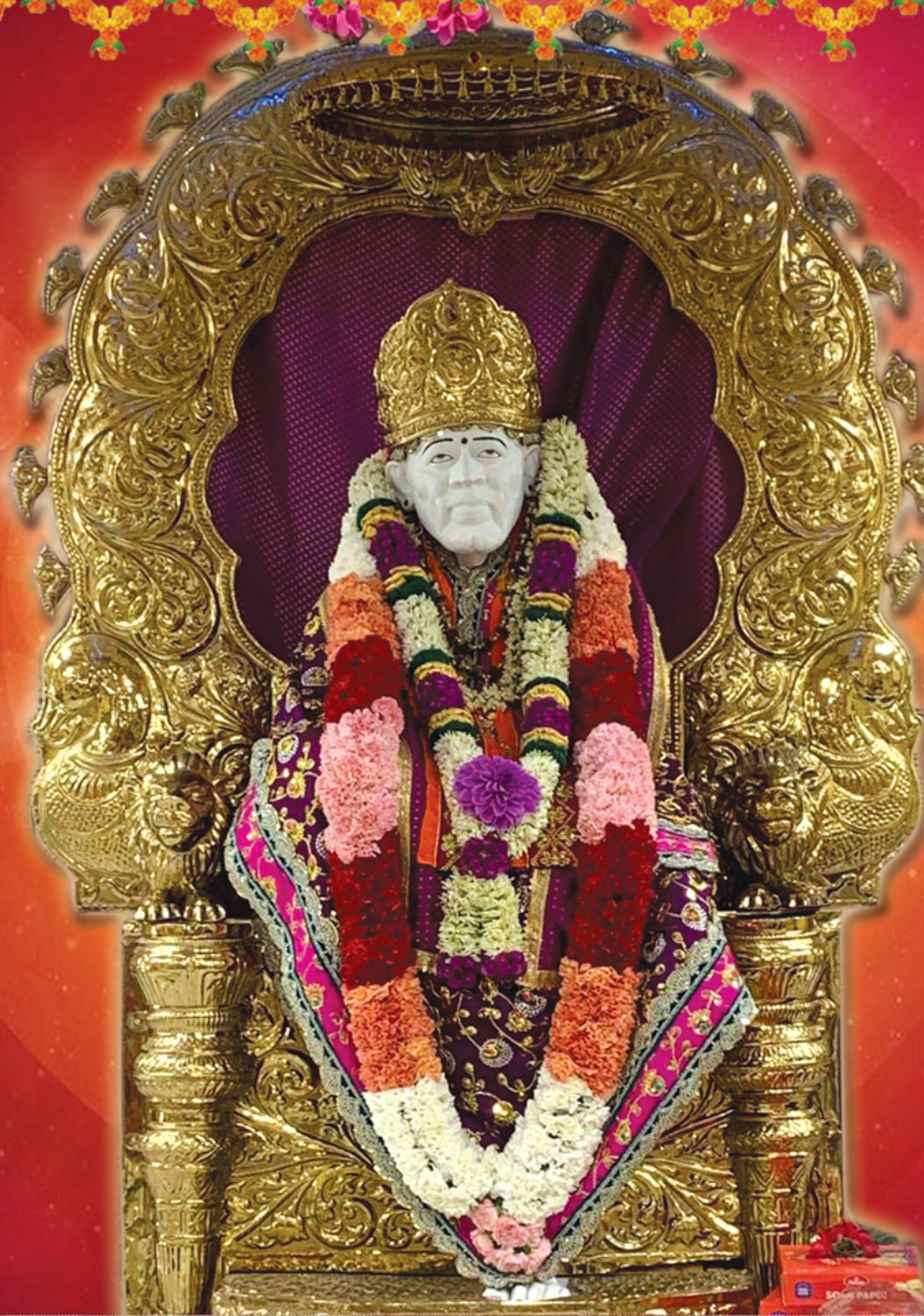

**Every**  
**Sankatahara**  
**Chaturthi 6:30 pm**  
**Ganapathi**  
**Abhishekam**

**Every**  
**Full Moon day**  
**Group**  
**Satyanarayana**  
**Vratam**

**Every Last**  
**Saturday 6:30 pm**  
**Ayyappa Padi Pooja**



# SAI TEMPLE MALVERN



# JUNE 2026



170 Planebrook Rd, Malvern, PA 19355  
Tel : 610-296-2039, 510-644-2596  
www.saitemplemalvern.com  
info@saitemplepa.com

PARABHAVA, AYANA : UTTARA – DAKSHINA, RITU : GRISHMA-VARSHA, ADHIKA JYESTHA – NIJA JYESTHA, VRISHABHA - MITHUNA, VAIKASI - AANI

## SUN (BHANU) MON (INDU) TUE (BHAUMA) WED (SAUMYA) THU (BRUHASPATHI) FRI (BHRUGU) SAT (STHIRA)

<b>1</b> T: PRATIPADA 07:07 N: JYESTHA 09:38 VA: 18:38-20:25 RK: 07:26-09:18 SR: 05:35 SS: 20:25	<b>2</b> T: DWITIYA 09:31 N: MULA 12:36 VA: 10:48-12:36 VA: 23:21-25:09+ RK: 16:43-18:34 YG: 09:18-11:09 SR: 05:35 SS: 20:26	<b>3</b> T: TRITIYA 11:51 N: P.ASHADHA 15:29 VA: 24:23+26:10+ RK: 13:00-14:52 YG: 07:26-09:17 SR: 05:34 SS: 20:26	<b>4</b> T: CHATURTHI 14:00 N: U.ASHADHA 18:11 VA: 22:35-24:20+ RK: 14:52-16:44 YG: 05:34-07:26 SR: 05:34 SS: 20:27	<b>5</b> T: PANCHAMI 15:50 N: SHRAVANA 20:33 VA: 24:52+26:35+ RK: 11:09-13:01 YG: 16:44-18:36 SR: 05:34 SS: 20:28	<b>6</b> T: SHASHTHI 17:10 N: DHANISHTHA 22:25 RK: 09:17-11:09 YG: 14:53-16:45 SR: 05:33 SS: 20:28	
<b>7</b> T: SAPTAMI 17:54 N: SHATABHISHA 23:39 VA: 06:00-07:40 RK: 18:37-20:29 YG: 13:01-14:53 SR: 05:33 SS: 20:29	<b>8</b> T: ASHTAMI 17:53 N: P.BHADRAPADA 24:09+ VA: 06:11-07:49 RK: 07:25-09:17 YG: 11:09-13:01 SR: 05:33 SS: 20:29	<b>9</b> T: NAVAMI 17:04 N: U.BHADRAPADA 23:51 VA: 09:38-11:13 RK: 16:46-18:38 YG: 09:17-11:09 SR: 05:33 SS: 20:30	<b>10</b> T: DASHAMI 15:27 N: REVATI 22:46 VA: 11:19-12:50 RK: 13:02-14:54 YG: 07:25-09:17 SR: 05:33 SS: 20:31	<b>11</b> T: EKADASHI 13:06 N: ASHWINI 20:58 VA: 17:16-18:45 RK: 14:54-16:46 YG: 05:33-07:25 SR: 05:33 SS: 20:31	<b>12</b> T: DWADASHI 10:06 N: BHARANI 18:35 VA: 05:37-07:03 VA: 29:11+06:35 on 13 <sup>th</sup> RK: 11:10-13:02 YG: 16:47-18:39 SR: 05:33 SS: 20:32	
<b>14</b> T: AMAVASYA 22:53 N: ROHINI 12:43 VA: 05:44-07:08 VA: 17:36-19:00 RK: 18:40-20:32 YG: 13:02-14:55 SR: 05:32 SS: 20:32	<b>15</b> T: PRATIPADA 19:00 N: MRIGASHIRA 09:38 VA: 17:00-18:25 RK: 07:25-09:18 YG: 11:10-13:03 SR: 05:32 SS: 20:33	<b>16</b> T: DWITIYA 15:22 N: ARDRA 06:42 N: PUNARVASU 28:07+ VA: 17:24-18:50 RK: 16:48-18:41 YG: 09:18-11:10 SR: 05:33 SS: 20:33	<b>17</b> T: TRITIYA 12:08 N: PUSHYA 26:02+ VA: 11:25-12:53 RK: 13:03-14:56 YG: 07:25-09:18 SR: 05:33 SS: 20:33	<b>18</b> T: CHATURTHI 09:28 N: ASHLESHA 24:36+ VA: 14:04-15:35 RK: 14:56-16:49 YG: 05:33-07:25 SR: 05:33 SS: 20:34	<b>19</b> T: PANCHAMI 07:29 N: MAGHA 23:55 VA: 12:16-13:49 RK: 11:11-13:03 YG: 16:49-18:41 SR: 05:33 SS: 20:34	
<b>21</b> T: SAPTAMI 05:50 N: U.PHALGUNI 24:52+ VA: 07:28-09:08 RK: 18:42-20:34 YG: 13:04-14:57 SR: 05:33 SS: 20:34	<b>22</b> T: ASHTAMI 06:09 N: HASTA 26:24+ VA: 09:48-11:30 RK: 07:26-09:19 YG: 11:11-13:04 SR: 05:33 SS: 20:35	<b>23</b> SR: 05:34 SS: 20:35 T: NAVAMI 07:09 N: CHITRA 28:29+ RK: 16:50-18:42 YG: 09:19-11:12 VA: 11:05-12:50	<b>24</b> T: DASHAMI 08:42 N: SWATI FULL NIGHT VA: 10:40-12:26 RK: 13:04-14:57 YG: 07:27-09:19 SR: 05:34 SS: 20:35	<b>25</b> T: EKADASHI 10:39 N: SWATI 06:59 VA: 13:14-15:01 RK: 14:57-16:50 YG: 05:34-07:27 SR: 05:34 SS: 20:35	<b>26</b> T: DWADASHI 12:52 N: VISHAKHA 09:46 VA: 14:15-16:02 RK: 11:12-13:05 YG: 16:50-18:43 SR: 05:35 SS: 20:35	
<b>28</b> T: CHATURDASHI 17:36 N: JYESTHA 15:38 VA: 24:37+26:24+ RK: 18:43-20:35 YG: 13:05-14:58 SR: 05:35 SS: 20:35	<b>29</b> T: PURNIMA 19:56 N: MULA 18:33 VA: 16:46-18:33 VA: 29:16+07:04 on 30 <sup>th</sup> RK: 07:28-09:21 YG: 11:13-13:05 SR: 05:36 SS: 20:35	<b>30</b> T: PRATIPADA 22:08 N: P.ASHADHA 21:21 RK: 16:50-18:43 YG: 09:21-11:13 SR: 05:36 SS: 20:35	<b>FESTIVALS</b> 03 SANKATAHARA CHATURTHI 05 WORLD ENVIRONMENT DAY 11 PARAMA EKADASHI 12 PRADOSHA VRATAM 13 MASA SHIVARATRI 15 MITHUNA SANKRANTI 19 SKANDA SASHTI 21 FATHER'S DAY INTERNATIONAL YOGA DAY 24 NIRJALA EKADASHI 25 RAMALAKSHMANA DWADASHI 26 PRADOSHA VRATAM 28 VAT PURNIMA VRATAM			

PANCHANGA BY DR. MURALI BHUVANAGIRI CALCULATED AS PER MALVERN, PA, USA'S LONGITUDE & LATITUDE, WHEN TITHI OR NAKSHATRA ENDS PAST MIDNIGHT "MON/DATE" IS INDICATED AS HINDU DAY IS FROM ONE SUNRISE TO ANOTHER SUNRISE. TITHI, NAKSHATRA TIMINGS ARE END TIMES, WHEN ONE ENDS ANOTHER BEGINS. '+' SYMBOL INDICATES NEXT DAY

**THE MORTGAGEIST**  
YOUR MORTGAGE SPECIALIST

**Apeksha Sista** NMLS# 2692605  
**(610) 836-2332**

**Kumar Sista** NMLS# 2369551  
**(610) 618-0618**

**Your Very Own Loan Officer**

The Mortgageist, NMLS# 2710734, 150 Allendale Rd, Ste. 2200, King of Prussia, PA 19406

**EXPERIOR**  
FINANCIAL GROUP, INC

**Srikanth Katupilla**  
724 689 7999  
skatupilla@experiorfinancialgroup.com

**Ashish Joshi**  
717 395 6154  
ajoshi@experiorfinancialgroup.com

- College Saving Plans
- Tax Saving Plans
- Mortgage Protection
- Retirement Strategies
- Business Coaching & Mentoring

Estate Planning / Will and Trust  
Credit Score Fix Services  
Wealth building, protection & recovery  
Legal Protection Services  
Life Insurance & Long term Care



Every  
Monday 6:30 pm  
Shiva Abhishekam

Every  
Thursday 10:30 am  
Baba Abhishekam

Every  
2nd Tuesday 6:30 pm  
Muragan Abhishekam

Every  
1st Friday 6:30 pm  
Sri Chakra Abhishekam

Every  
Saturday 10:30 am  
Balaji Abhishekam

Every  
Sankatahara  
Chaturthi 6:30 pm  
Ganapathi  
Abhishekam

Every  
Full Moon day  
Group  
Satyanarayana  
Vratam

Every Last  
Saturday 6:30 pm  
Ayyappa Padi Pooja



# SAI TEMPLE MALVERN



# JULY 2026



170 Planebrook Rd, Malvern, PA 19355  
Tel : 610-296-2039, 510-644-2596  
www.saitemplemalvern.com  
info@saitemplepa.com

PARABHAVA, AYANA : DAKSHINA, RITU : VARSHA, NIJA JYESTHA – ASHADHA, MITHUNA - KARKA, AANI - AADI

## SUN (BHANU) MON (INDU) TUE (BHAUMA) WED (SAUMYA) THU (BRUHASPATHI) FRI (BHRUGU) SAT (STHIRA)

SUN (BHANU)	MON (INDU)	TUE (BHAUMA)	WED (SAUMYA)	THU (BRUHASPATHI)	FRI (BHRUGU)	SAT (STHIRA)
<b>FESTIVALS</b> 03 SANKATAHARA CHATURTHI 10 YOGINI EKADASHI 11 SHANI TRAYODASHI PRADOSHA VRATAM 12 MASA SHIVARATRI	15 JAGANNATH RATHYATRA 16 KARKATAKA SANKRANTI 18 SKANDA SASHTI 24 DEVSHAYANI EKADASHI 25 VASUDEVA DWADASHI 26 PRADOSHA VRATAM	28 KOKILA VRATAM GURU PURNIMA PURNIMA VRATAM	<b>1</b> T: DWITIYA 24:07+ N: U.ASHADHA 23:57 VA: 06:13-07:59 VA: 28:20+06:05 on 2 <sup>nd</sup> RK: 13:06-14:58 YG: 07:29-09:21 SR: 05:37 SS: 20:35	<b>2</b> T: TRITIYA 25:50+ N: SHRAVANA 26:16+ RK: 14:58-16:50 YG: 05:37-07:30 SR: 05:37 SS: 20:35	<b>3</b> T: CHATURTHI 27:09+ N: DHANISHTHA 28:13+ VA: 06:36-08:20 RK: 11:14-13:06 YG: 16:50-18:42 SR: 05:38 SS: 20:35	<b>4</b> T: PANCHAMI 28:00+ N: SHATABHISHA FULL NIGHT VA: 11:52-13:34 RK: 09:22-11:14 YG: 14:58-16:50 SR: 05:38 SS: 20:34
<b>5</b> T: SHASHTHI 28:17+ N: SHATABHISHA 05:42 VA: 12:21-14:01 RK: 18:42-20:34 YG: 13:07-14:58 SR: 05:39 SS: 20:34	<b>6</b> T: SAPTAMI 27:54+ N: P.BHADRAPADA 06:37 VA: 16:20-17:57 RK: 07:31-09:23 YG: 11:15-13:07 SR: 05:40 SS: 20:34	<b>7</b> T: ASHTAMI 26:51+ N: U.BHADRAPADA 06:54 VA: 18:42-20:16 RK: 16:50-18:42 YG: 09:24-11:15 SR: 05:40 SS: 20:34	<b>8</b> T: NAVAMI 25:07+ N: REVATI 06:30 VA: 18:21-15:51 VA: 25:36+27:08+ RK: 13:07-14:59 YG: 07:32-09:24 SR: 05:41 SS: 20:33	<b>9</b> T: DASHAMI 22:46 N: BHARANI 27:45+ VA: 14:21-15:51 RK: 14:59-16:50 YG: 05:42-07:33 SR: 05:42 SS: 20:33	<b>10</b> T: EKADASHI 19:52 N: KRITTIKA 25:33+ VA: 14:39-16:06 RK: 11:16-13:07 YG: 16:50-18:41 SR: 05:42 SS: 20:32	<b>11</b> T: DWADASHI 16:34 N: ROHINI 22:59 VA: 15:50-17:16 VA: 27:56+29:20+ RK: 09:25-11:16 YG: 14:59-16:50 SR: 05:43 SS: 20:32
<b>12</b> T: TRAYODASHI 12:59 N: MRIGASHIRA 20:11 VA: 27:36+29:00+ RK: 18:41-20:32 YG: 13:08-14:59 SR: 05:44 SS: 20:32	<b>13</b> <sup>o</sup> T: CHATURDASHI 09:19 T: AMAVASYA 29:42+ N: ARDRA 17:21 VA: 28:00+29:25+ RK: 07:35-09:26 YG: 11:17-13:08 SR: 05:44 SS: 20:31	<b>14</b> T: PRATIPADA 26:20+ N: PUNARVASU 14:39 VA: 21:52-23:18 RK: 16:49-18:40 YG: 09:26-11:17 SR: 05:45 SS: 20:30	<b>15</b> T: DWITIYA 23:22 N: PUSHYA 12:16 VA: 24:03+25:32+ RK: 13:08-14:58 YG: 07:36-09:27 SR: 05:46 SS: 20:30	<b>16</b> T: TRITIYA 20:57 N: ASHLESHA 10:22 VA: 21:43-23:14 RK: 14:58-16:49 YG: 05:47-07:37 SR: 05:47 SS: 20:29	<b>17</b> T: CHATURTHI 19:12 N: MAGHA 09:04 VA: 16:53-18:27 RK: 11:18-13:08 YG: 16:48-18:39 SR: 05:47 SS: 20:29	<b>18</b> T: PANCHAMI 18:12 N: P.PHALGUNI 08:30 VA: 15:46-17:22 RK: 09:28-11:18 YG: 14:58-16:48 SR: 05:48 SS: 20:28
<b>19</b> T: SHASHTHI 17:59 N: U.PHALGUNI 08:42 VA: 17:26-19:06 RK: 18:38-20:27 YG: 13:08-14:58 SR: 05:49 SS: 20:27	<b>20</b> T: SAPTAMI 18:32 N: HASTA 09:39 VA: 18:12-19:55 RK: 07:39-09:29 YG: 11:19-13:08 SR: 05:50 SS: 20:27	<b>21</b> T: ASHTAMI 19:46 N: CHITRA 11:19 VA: 17:26-19:11 RK: 16:47-18:36 YG: 09:29-11:19 SR: 05:51 SS: 20:26	<b>22</b> T: NAVAMI 21:33 N: SWATI 13:33 VA: 19:46-21:33 RK: 13:08-14:57 YG: 07:41-09:30 SR: 05:52 SS: 20:25	<b>23</b> T: DASHAMI 23:42 N: VISHAKHA 16:12 VA: 20:41-22:29 RK: 14:57-16:46 YG: 05:52-07:41 SR: 05:52 SS: 20:24	<b>24</b> T: EKADASHI 26:04+ N: ANURADHA 19:06 VA: 25:24+27:12+ RK: 11:20-13:08 YG: 16:46-18:35 SR: 05:53 SS: 20:23	<b>25</b> T: DWADASHI 28:27+ N: JYESTHA 22:04 VA: 09:31-11:20 YG: 14:57-16:45 SR: 05:54 SS: 20:23
<b>26</b> T: TRAYODASHI FULL NIGHT N: MULA 24:58+ VA: 07:02-08:50 VA: 23:11-24:58+ RK: 18:33-20:22 YG: 13:08-14:57 SR: 05:55 SS: 20:22	<b>27</b> T: TRAYODASHI 06:44 N: P.ASHADHA 27:41+ VA: 11:39-13:26 RK: 07:44-09:32 YG: 11:20-13:08 SR: 05:56 SS: 20:21	<b>28</b> T: CHATURDASHI 08:48 N: U.ASHADHA FULL NIGHT VA: 12:29-14:15 VA: 16:44-18:32 RK: 09:33-11:20 SR: 05:57 SS: 20:20	<b>29</b> <sup>o</sup> T: PURNIMA 10:35 N: U.ASHADHA 06:07 VA: 10:28-12:12 RK: 13:08-14:56 YG: 07:45-09:33 SR: 05:58 SS: 20:19	<b>30</b> T: PRATIPADA 12:00 N: SHRAVANA 08:13 VA: 12:30-14:13 RK: 14:56-16:43 YG: 05:59-07:46 SR: 05:59 SS: 20:18	<b>31</b> T: DWITIYA 13:01 N: DHANISHTHA 09:56 VA: 17:32-19:13 RK: 11:21-13:08 YG: 16:43-18:30 SR: 06:00 SS: 20:17	

PANCHANGA BY DR. MURALI BHUVANAGIRI CALCULATED AS PER MALVERN, PA, USA'S LONGITUDE & LATITUDE, WHEN TITHI OR NAKSHATRA ENDS PAST MIDNIGHT "MON/DATE" IS INDICATED AS HINDU DAY IS FROM ONE SUNRISE TO ANOTHER SUNRISE. TITHI, NAKSHATRA TIMINGS ARE END TIMES, WHEN ONE ENDS ANOTHER BEGINS. '+' SYMBOL INDICATES NEXT DAY

**THE MORTGAGEIST**  
YOUR MORTGAGE SPECIALIST

**Apeksha Sista** NMLS# 2692605  
**(610) 836-2332**

**Kumar Sista** NMLS# 2369551  
**(610) 618-0618**

Your Very Own Loan Officer

The Mortgageist, NMLS# 2710734, 150 Allendale Rd, Ste. 2200, King of Prussia, PA 19406

**EXPERIOR**  
FINANCIAL GROUP, INC

**Srikanth Katupilla**  
724 689 7999  
skatupilla@experiorfinancialgroup.com

**Ashish Joshi**  
717 395 6154  
ajoshi@experiorfinancialgroup.com

- College Saving Plans
- Tax Saving Plans
- Mortgage Protection
- Retirement Strategies
- Business Coaching & Mentoring

Estate Planning / Will and Trust  
Credit Score Fix Services  
Wealth building, protection & recovery  
Legal Protection Services  
Life Insurance & Long term Care



*Exton's Largest  
One-Stop  
Indian Grocery*

SYMBOL OF PURITY

**APNA  
BAZAR**

*4 Tabas Lane,  
Exton, PA, 19341*

*Fresh & High Quality*



SHOP NOW

+1 484-879-4198





# SAI TEMPLE MALVERN



# AUGUST 2026



170 Planebrook Rd, Malvern, PA 19355  
Tel : 610-296-2039, 510-644-2596  
www.saitemplemalvern.com  
info@saitemplepa.com

PARABHAVA, AYANA : DAKSHINA, RITU : VARSHA - SHARAD, ASHADHA - SHRAVANA, KARKA - SIMHA, AADI - AAVANI

## SUN (BHANU) MON (INDU) TUE (BHAUMA) WED (SAUMYA) THU (BRUHASPATHI) FRI (BHRUGU) SAT (STHIRA)

**30** T: TRITIYA 23:20  
N: U.BHADRAPADA 18:14  
VA: 30:04+07:38 on 31<sup>st</sup>  
RK: 17:58-19:37  
YG: 13:02-14:41  
SR: 06:28 SS: 19:37

**31** T: CHATURTHI 22:11  
N: REVATI 17:53  
RK: 08:07-09:46  
YG: 11:24-13:02  
SR: 06:29 SS: 19:35



**FESTIVALS**  
01 SANKATAHARA CHATURTHI  
02 FRIENDSHIP DAY  
08 KAMIKA EKADASHI  
10 PRADOSHA VRATAM  
MASA SHIVARATRI  
16 SIMHA SANKRANTI

17 SKANDA SASHTI  
21 VARALAKSHMI VRATAM  
23 PUTRADA EKADASHI  
24 DAMODARA DWADASHI  
25 PRADOSHA VRATAM  
26 ONAM  
27 RAKSHA BANDHAN

27 PURNIMA VRATAM  
31 SANKATAHARA CHATURTHI  
12th AUGUST 2026  
**PARTIAL SOLAR ECLIPSE**  
STARTS - 01:10 PM. ENDS - 02:33 PM  
PARTIAL ECLIPSE DURATION -  
01 HOURS 22 MINS 14 SECS

27th AUGUST 2026  
**PARTIAL LUNAR ECLIPSE  
IN MALVERN**  
STARTS - 10:34 PM. ENDS - 1:51 AM 28<sup>th</sup>  
LOCAL ECLIPSE DURATION -  
03 HOURS 16 MINS 37 SECS

**1** T: TRITIYA 13:37  
N: SHATABHISHA 11:15  
VA: 17:53-19:32  
RK: 09:34-11:21  
YG: 14:55-16:42  
SR: 06:00 SS: 20:16



**2** T: CHATURTHI 13:45  
N: P.BHADRAPADA 12:07  
VA: 21:52-23:29  
RK: 18:28-20:15  
YG: 13:08-14:55  
SR: 06:01 SS: 20:15



**3** T: PANCHAMI 13:24  
N: U.BHADRAPADA 12:30  
VA: 24:27+26:02+  
RK: 07:49-09:35  
YG: 11:22-13:08  
SR: 06:02 SS: 20:14

**4** T: SHASHTHI 12:33  
N: REVATI 12:24  
VA: 16:40-18:26  
RK: 09:36-11:22  
SR: 06:03 SS: 20:12

**5** T: SAPTAMI 11:12  
N: ASHWINI 11:48  
VA: 07:54-09:27  
RK: 20:58-22:30  
YG: 13:08-14:54  
SR: 06:04 SS: 20:11

**6** T: ASHTAMI 09:22  
N: BHARANI 10:43  
VA: 21:58-23:28  
RK: 14:53-16:39  
YG: 06:05-07:51  
SR: 06:05 SS: 20:10

**7** T: NAVAMI 07:06  
N: DASHAMI 28:29+  
N: KRITTIKA 09:13  
VA: 23:58-25:27+  
RK: 11:22-13:08  
YG: 16:38-18:24  
SR: 06:06 SS: 20:09

**8** T: EKADASHI 25:34+  
N: ROHINI 07:21  
N: MRIGASHIRA 29:13+  
VA: 12:27-13:54  
RK: 09:37-11:22  
YG: 14:52-16:38  
SR: 06:07 SS: 20:08



**9** T: DWADASHI 22:30  
N: ARDRA 26:56+  
VA: 12:49-14:16  
RK: 18:22-20:07  
YG: 13:07-14:52  
SR: 06:08 SS: 20:07

**10** T: TRAYODASHI 19:24  
N: PUNARVASU 24:39+  
VA: 13:48-15:14  
RK: 07:54-09:38  
YG: 11:23-13:07  
SR: 06:09 SS: 20:05



**11** T: CHATURDASHI 16:22  
N: PUSHYA 22:29  
VA: 07:56-09:23  
RK: 16:35-18:20  
YG: 09:38-11:23  
SR: 06:10 SS: 20:04

**12** T: AMAVASYA 13:36  
N: ASHLESHA 20:36  
VA: 10:17-11:45  
RK: 13:07-14:51  
YG: 07:55-09:39  
SR: 06:11 SS: 20:03

**13** T: PRATIPADA 11:11  
N: MAGHA 19:08  
VA: 07:52-09:22  
RK: 26:49+28:22+  
RK: 14:50-16:34  
YG: 06:12-07:56  
SR: 06:12 SS: 20:01

**14** T: DWITIYA 09:16  
N: P.PHALGUNI 18:12  
VA: 25:19+26:54+  
RK: 11:23-13:06  
YG: 16:33-18:17  
SR: 06:13 SS: 20:00

**15** T: TRITIYA 07:58  
N: U.PHALGUNI 17:55  
VA: 26:28+28:06+  
RK: 09:40-11:23  
YG: 14:49-16:32  
SR: 06:14 SS: 19:59

**16** T: CHATURTHI 07:22  
N: HASTA 18:20  
VA: 26:43+28:24+  
RK: 18:15-19:57  
YG: 13:06-14:49  
SR: 06:15 SS: 19:57

**17** T: PANCHAMI 07:30  
N: CHITRA 19:28  
VA: 25:30+27:13+  
RK: 07:58-09:41  
YG: 11:23-13:06  
SR: 06:16 SS: 19:56



**18** T: SHASHTHI 08:20  
N: SWATI 21:16  
VA: 27:25+29:11+  
RK: 16:30-18:12  
YG: 09:41-11:23  
SR: 06:17 SS: 19:55

**19** T: SAPTAMI 09:49  
N: VISHAKHA 23:38  
VA: 28:05+29:52+  
RK: 13:05-14:47  
YG: 08:00-09:41  
SR: 06:18 SS: 19:53

**20** T: ASHTAMI 11:48  
N: ANURADHA 26:23+  
RK: 14:47-16:28  
YG: 06:19-08:00  
SR: 06:19 SS: 19:52



**21** T: NAVAMI 14:06  
N: JYESHTHA 29:19+  
VA: 08:40-10:27  
RK: 11:24-13:05  
YG: 16:28-18:09  
SR: 06:19 SS: 19:50



**22** T: DASHAMI 16:30  
N: MULA FULL NIGHT  
VA: 14:17-16:05  
RK: 09:43-11:24  
YG: 14:46-16:27  
SR: 06:20 SS: 19:49

**23** T: EKADASHI 18:48  
N: MULA 08:14  
VA: 06:27-08:14  
RK: 18:56-20:43  
YG: 18:07-19:47  
SR: 06:21 SS: 19:47



**24** T: DWADASHI 20:50  
N: P.ASHADHA 10:58  
VA: 19:46-21:31  
RK: 08:03-09:43  
YG: 11:24-13:04  
SR: 06:22 SS: 19:46

**25** T: TRAYODASHI 22:29  
N: U.ASHADHA 13:21  
VA: 17:40-19:24  
RK: 16:24-18:04  
YG: 09:44-11:24  
SR: 06:23 SS: 19:44



**26** T: CHATURDASHI 23:38  
N: SHRAVANA 15:18  
VA: 19:32-21:14  
RK: 13:04-14:43  
YG: 08:04-09:44  
SR: 06:24 SS: 19:43



**27** T: PURNIMA 24:18+  
N: DHANISHTHA 16:45  
VA: 24:15+25:54+  
RK: 14:43-16:22  
YG: 06:25-08:05  
SR: 06:25 SS: 19:41



**28** T: PRATIPADA 24:26+  
N: SHATABHISHA 17:43  
VA: 24:15+25:52+  
RK: 11:24-13:03  
YG: 16:21-18:01  
SR: 06:26 SS: 19:40

**29** T: DWITIYA 24:06+  
N: P.BHADRAPADA 18:12  
VA: 27:49+29:25+  
RK: 09:45-11:24  
YG: 14:42-16:20  
SR: 06:27 SS: 19:38

PANCHANGA BY DR. MURALI BHUVANAGIRI CALCULATED AS PER MALVERN, PA, USA'S LONGITUDE & LATITUDE, WHEN TITHI OR NAKSHATRA ENDS PAST MIDNIGHT "MON/DATE" IS INDICATED AS HINDU DAY IS FROM ONE SUNRISE TO ANOTHER SUNRISE. TITHI, NAKSHATRA TIMINGS ARE END TIMES, WHEN ONE ENDS ANOTHER BEGINS. '+' SYMBOL INDICATES NEXT DAY



**Apeksha Sista**  
NMLS# 2692605

**(610) 836-2332**

**Your Very Own Loan Officer**

The Mortgageist, NMLS# 2710734, 150 Allendale Rd, Ste. 2200, King of Prussia, PA 19406

**Kumar Sista**  
NMLS# 2369551

**(610) 618-0618**



**Srikanth Katupilla**  
724 689 7999  
skatupilla@experiorfinancialgroup.com



**Ashish Joshi**  
717 395 6154  
ajoshi@experiorfinancialgroup.com

- College Saving Plans
- Tax Saving Plans
- Mortgage Protection
- Retirement Strategies
- Business Coaching & Mentoring

- Estate Planning / Will and Trust
- Credit Score Fix Services
- Wealth building, protection & recovery
- Legal Protection Services
- Life Insurance & Long term Care



Every  
Monday 6:30 pm  
Shiva Abhishekam

Every  
Thursday 10:30 am  
Baba Abhishekam

Every  
2nd Tuesday 6:30 pm  
Muragan Abhishekam

Every  
1st Friday 6:30 pm  
Sri Chakra Abhishekam

Every  
Saturday 10:30 am  
Balaji Abhishekam

Every  
Sankatahara  
Chaturthi 6:30 pm  
Ganapathi  
Abhishekam

Every  
Full Moon day  
Group  
Satyanarayana  
Vratam

Every Last  
Saturday 6:30 pm  
Ayyappa Padi Pooja



# SAI TEMPLE MALVERN



# SEPTEMBER 2026



170 Planebrook Rd, Malvern, PA 19355  
 Tel : 610-296-2039, 510-644-2596  
[www.saitemplemalvern.com](http://www.saitemplemalvern.com)  
[info@saitemplepa.com](mailto:info@saitemplepa.com)

PARABHAVA, AYANA : DAKSHINA, RITU : SHARAD, SHRAVANA – BHADRAPADA, SIMHA - KANYA, AAVANI - PURATTASI

**SUN (BHANU) MON (INDU) TUE (BHAUMA) WED (SAUMYA) THU (BRUHASPATHI) FRI (BHRUGU) SAT (STHIRA)**



**1** T: PANCHAMI 20:42  
 N: ASHWINI 17:12  
 VA: 13:19-14:52  
 VA: 26:24-27:56+  
 RK: 16:18-17:56  
 YG: 09:46-11:24  
 SR: 06:30 SS: 19:34

**2** T: SHASHTHI 18:55  
 N: BHARANI 16:13  
 VA: 27:36+29:07+  
 RK: 13:01-14:39  
 YG: 08:09-09:46  
 SR: 06:31 SS: 19:32

**3** T: SAPTAMI 16:55  
 N: KRITTIKA 14:59  
 VA: 30:02+07:32 on 4<sup>th</sup>  
 RK: 14:38-16:16  
 YG: 06:32-08:09  
 SR: 06:32 SS: 19:30

**4** T: ASHTAMI 14:43  
 N: ROHINI 13:34  
 VA: 18:48-20:18  
 RK: 11:24-13:01  
 YG: 16:15-17:52  
 SR: 06:33 SS: 19:29

**5** T: NAVAMI 12:23  
 N: MRIGASHIRA 12:00  
 VA: 19:50-21:19  
 RK: 09:47-11:24  
 YG: 14:37-16:14  
 SR: 06:34 SS: 19:27

**6** T: DASHAMI 09:59  
 N: ARDRA 10:22  
 VA: 21:33-23:02  
 RK: 17:49-19:26  
 YG: 13:00-14:36  
 SR: 06:35 SS: 19:26

**7** T: EKADASHI 07:33  
 N: DWADASHI 29:12+  
 N: PUNARVASU 08:44  
 VA: 16:12-17:42  
 RK: 08:12-09:48  
 YG: 11:24-13:00  
 SR: 06:36 SS: 19:24

**8** T: TRAYODASHI 27:00+  
 N: PUSHYA 07:09  
 N: ASHLESHA 29:44+  
 VA: 19:12-20:42  
 RK: 16:11-17:47  
 YG: 09:48-11:24  
 SR: 06:37 SS: 19:22

**9** T: CHATURDASHI 25:03+  
 N: MAGHA 28:34+  
 N: SHARADHA 17:09-18:40  
 RK: 12:59-14:34  
 YG: 08:13-09:48  
 SR: 06:38 SS: 19:21

**10** T: AMAVASYA 23:26  
 N: P.PHALGUNI 27:46+  
 VA: 12:18-13:51  
 RK: 14:34-16:09  
 YG: 06:38-08:14  
 SR: 06:38 SS: 19:19

**11** T: PRATIPADA 22:16  
 N: U.PHALGUNI 27:25+  
 VA: 10:51-12:26  
 RK: 11:24-12:58  
 YG: 16:08-17:43  
 SR: 06:39 SS: 19:17

**12** T: DWITIYA 21:38  
 N: HASTA 27:37+  
 VA: 11:53-13:30  
 RK: 09:49-11:24  
 YG: 14:32-16:07  
 SR: 06:40 SS: 19:16

**13** T: TRITIYA 21:36  
 N: CHITRA 28:25+  
 VA: 11:53-13:32  
 RK: 17:40-19:14  
 YG: 12:58-14:32  
 SR: 06:41 SS: 19:14

**14** T: CHATURTHI 22:14  
 N: SWATI 29:51+  
 VA: 10:21-12:03  
 RK: 08:16-09:50  
 YG: 11:24-12:57  
 SR: 06:42 SS: 19:12

**15** T: PANCHAMI 23:29  
 N: VISHAKHA FULL NIGHT  
 VA: 11:55-13:39  
 RK: 16:04-17:37  
 YG: 09:50-11:24  
 SR: 06:43 SS: 19:11

**16** T: SHASHTHI 25:17+  
 N: VISHAKHA 07:52  
 VA: 12:17-14:03  
 RK: 12:57-14:30  
 YG: 08:17-09:50  
 SR: 06:44 SS: 19:09

**17** T: SAPTAMI 27:30+  
 N: ANURADHA 10:23  
 VA: 16:39-18:27  
 RK: 14:29-16:02  
 YG: 06:45-08:18  
 SR: 06:45 SS: 19:07

**18** T: ASHTAMI 29:56+  
 N: JYESTHA 13:14  
 VA: 22:14-24:02+  
 RK: 11:23-12:56  
 YG: 16:01-17:33  
 SR: 06:46 SS: 19:06

**19** T: NAVAMI FULL NIGHT  
 N: MULA 16:13  
 VA: 14:25-16:13  
 VA: 26:57+28:45+  
 RK: 09:51-11:23  
 YG: 14:28-16:00  
 SR: 06:47 SS: 19:04

**20** T: NAVAMI 08:21  
 N: P.ASHADHA 19:04  
 VA: 27:55+29:41+  
 RK: 17:31-19:02  
 YG: 12:55-14:27  
 SR: 06:48 SS: 19:02

**21** T: DASHAMI 10:30  
 N: U.ASHADHA 21:36  
 VA: 25:57+27:41+  
 RK: 08:20-09:52  
 YG: 11:23-12:55  
 SR: 06:49 SS: 19:01

**22** T: EKADASHI 12:13  
 N: SHRAVANA 23:39  
 VA: 27:53+29:35+  
 RK: 15:57-17:28  
 YG: 09:52-11:23  
 SR: 06:50 SS: 18:59

**23** T: DWADASHI 13:20  
 N: DHANISHTHA 25:05+  
 VA: 12:54-14:25  
 RK: 08:22-09:52  
 YG: 06:51 SS: 18:57

**24** T: TRAYODASHI 13:48  
 N: SHATABHISHA 25:52+  
 VA: 08:31-10:10  
 RK: 14:24-15:55  
 YG: 06:52-08:22  
 SR: 06:52 SS: 18:56

**25** T: CHATURDASHI 13:36  
 N: P.BHADRAPADA 26:02+  
 VA: 08:19-09:55  
 RK: 11:23-12:53  
 YG: 15:54-17:24  
 SR: 06:53 SS: 18:54

**26** T: PURNIMA 12:48  
 N: U.BHADRAPADA 25:38+  
 VA: 11:28-13:02  
 RK: 09:53-11:23  
 YG: 14:23-15:53  
 SR: 06:54 SS: 18:53

**27** T: PRATIPADA 11:28  
 N: REVATI 24:46+  
 VA: 13:12-14:44  
 RK: 17:21-18:51  
 YG: 12:53-14:22  
 SR: 06:55 SS: 18:51

**28** T: DWITIYA 09:43  
 N: ASHWINI 23:33  
 VA: 19:45-21:16  
 RK: 08:25-09:54  
 YG: 11:23-12:52  
 SR: 06:56 SS: 18:49

**29** T: TRITIYA 07:39  
 N: CHATURTHI 29:25+  
 N: BHARANI 22:06  
 VA: 08:34-10:04  
 RK: 15:50-17:19  
 YG: 09:54-11:23  
 SR: 06:57 SS: 18:48

**30** T: PANCHAMI 27:05+  
 N: KRITTIKA 20:32  
 VA: 09:19-10:49  
 RK: 12:52-14:20  
 YG: 08:26-09:55  
 SR: 06:58 SS: 18:46

**FESTIVALS**  
 01 NAG PANCHAMI  
 03 KRISHNA JANMASHTAMI  
 06 AJA EKADASHI  
 08 PRADOSHA VRATAM  
 MASA SHIVARATRI  
 13 VARAHA JAYANTI

14 VINAYAKA CHAVITHI  
 15 RISHI PANCHAMI  
 16 BALARAMA JAYANTI  
 VISHWAKARMA PUJA  
 KANYA SANKRANTI  
 SKANDA SASHTI

22 VAMANA JAYANTI  
 PARVA EKADASHI  
 23 PRADOSHA VRATAM  
 25 ANANTA CHATURDASHI  
 PURNIMA VRATAM  
 26 PITRUPAKSHA BEGINS  
 29 SANKATAHARA CHATURTHI

PANCHANGA BY DR. MURALI BHUVANAGIRI CALCULATED AS PER MALVERN, PA, USA'S LONGITUDE & LATITUDE, WHEN TITHI OR NAKSHATRA ENDS PAST MIDNIGHT "MON/DATE" IS INDICATED AS HINDU DAY IS FROM ONE SUNRISE TO ANOTHER SUNRISE. TITHI, NAKSHATRA TIMINGS ARE END TIMES, WHEN ONE ENDS ANOTHER BEGINS. '+' SYMBOL INDICATES NEXT DAY

**THE MORTGAGEIST**  
 YOUR MORTGAGE SPECIALIST

**Apeksha Sista** NMLS# 2692605  
**Kumar Sista** NMLS# 2369551

**(610) 836-2332 (610) 618-0618**

**Your Very Own Loan Officer**

The Mortgageist, NMLS# 2710734, 150 Allendale Rd, Ste. 2200, King of Prussia, PA 19406

**EXPERIOR**  
 FINANCIAL GROUP, INC

**Srikanth Katupilla**  
 724 689 7999  
 skatupilla@experiorfinancialgroup.com

**Ashish Joshi**  
 717 395 6154  
 ajoshi@experiorfinancialgroup.com

- College Saving Plans
- Tax Saving Plans
- Mortgage Protection
- Retirement Strategies
- Business Coaching & Mentoring

Estate Planning / Will and Trust  
 Credit Score Fix Services  
 Wealth building, protection & recovery  
 Legal Protection Services  
 Life Insurance & Long term Care

Every  
Monday 6:30 pm  
Shiva Abhishekam

Every  
Thursday 10:30 am  
Baba Abhishekam

Every  
2nd Tuesday 6:30 pm  
Muragan Abhishekam

Every  
1st Friday 6:30 pm  
Sri Chakra Abhishekam

Every  
Saturday 10:30 am  
Balaji Abhishekam



Every  
Sankatahara  
Chaturthi 6:30 pm  
Ganapathi  
Abhishekam

Every  
Full Moon day  
Group  
Satyanarayana  
Vratam

Every Last  
Saturday 6:30 pm  
Ayyappa Padi Pooja



# SAI TEMPLE MALVERN



# OCTOBER 2026



170 Planebrook Rd, Malvern, PA 19355  
Tel : 610-296-2039, 510-644-2596  
www.saitemplemalvern.com  
info@saitemplepa.com

PARABHAVA, AYANA : DAKSHINA, RITU : SHARAD - HEMANT BHADRAPADA - ASHVAYUJA, KANYA - TULA, PURATTASI - AIPPASI

## SUN (BHANU) MON (INDU) TUE (BHAUMA) WED (SAUMYA) THU (BRUHASPATHI) FRI (BHRUGU) SAT (STHIRA)

SUN (BHANU)	MON (INDU)	TUE (BHAUMA)	WED (SAUMYA)	THU (BRUHASPATHI)	FRI (BHRUGU)	SAT (STHIRA)
<b>FESTIVALS</b> 06 INDIRA EKADASHI 07 PRADOSHA VRATAM 08 MASA SHIVARATRI 11 DEVI NAVRATRI BEGINS 14 UPANG LALITA VRATAM	15 SKANDA SASHTI 17 SARASWATI PUJA TULA SANKRANTI 18 DURGA ASHTAMI 19 MAHA NAVAMI 20 VIJAYADASHAMI	21 PAPANKUSHA EKADASHI 22 PADMANABHA DWADASHI 23 PRADOSHA VRATAM 25 PURNIMA VRATAM 28 KARWA CHAOUTH, ATLA TADDE SANKATAHARA CHATURTHI		<b>1</b> T: SHASHTHI 24:45+ N: ROHINI 18:57 VA: 11:29-12:58 VA: 24:11+25:41+ RK: 14:20-15:48 YG: 06:59-08:27 SR: 06:59 SS: 18:44	<b>2</b> T: SAPTAMI 22:29 N: MRIGASHIRA 17:25 VA: 25:19+26:49+ RK: 11:23-12:51 YG: 15:47-17:15 SR: 06:59 SS: 18:43	<b>3</b> T: ASHTAMI 20:21 N: ARDRA 15:59 VA: 27:21+28:52+ RK: 09:56-11:23 YG: 14:18-15:46 SR: 07:00 SS: 18:41
<b>4</b> T: NAVAMI 18:23 N: PUNARVASU 14:43 VA: 22:22-23:54 RK: 17:12-18:39 YG: 12:50-14:18 SR: 07:01 SS: 18:39	<b>5</b> T: DASHAMI 16:37 N: PUSHYA 13:39 VA: 25:59+27:32+ RK: 08:29-09:56 YG: 11:23-12:50 SR: 07:02 SS: 18:38	<b>6</b> T: EKADASHI 15:04 N: ASHLESHA 12:47 VA: 24:28+26:02+ RK: 15:43-17:10 YG: 09:57-11:23 SR: 07:03 SS: 18:36	 <b>7</b> T: DWADASHI 13:46 N: MAGHA 12:10 VA: 20:03-21:38 RK: 12:50-14:16 YG: 08:31-09:57 SR: 07:04 SS: 18:35	<b>8</b> T: TRAYODASHI 12:45 N: P.PHALGUNI 11:50 VA: 19:02-20:38 RK: 14:15-15:41 YG: 07:05-08:31 SR: 07:05 SS: 18:33	<b>9</b> T: CHATURDASHI 12:05 N: U.PHALGUNI 11:49 VA: 20:21-21:59 RK: 11:23-12:49 YG: 15:40-17:06 SR: 07:06 SS: 18:32	<b>10</b> T: AMAVASYA 11:49 N: HASTA 12:12 VA: 20:29-22:08 RK: 09:58-11:23 YG: 14:14-15:39 SR: 07:08 SS: 18:30
<b>11</b> T: PRATIPADA 12:00 N: CHITRA 13:02 VA: 18:57-20:38 RK: 17:03-18:28 YG: 12:48-14:13 SR: 07:09 SS: 18:28	<b>12</b> T: DWITIYA 12:43 N: SWATI 14:22 VA: 20:24-22:07 RK: 08:34-09:59 YG: 11:24-12:48 SR: 07:10 SS: 18:27	<b>13</b> T: TRITIYA 13:57 N: VISHAKHA 16:13 VA: 20:36-22:21 RK: 15:37-17:01 YG: 09:59-11:24 SR: 07:11 SS: 18:25	<b>14</b> T: CHATURTHI 15:43 N: ANURADHA 18:33 VA: 24:47+26:34+ RK: 12:48-14:12 YG: 08:36-10:00 SR: 07:12 SS: 18:24	<b>15</b> T: PANCHAMI 17:55 N: JYESHTHA 21:17 VA: 30:17+08:05 on 16th RK: 14:11-15:35 YG: 07:13-08:36 SR: 07:13 SS: 18:22	<b>16</b> T: SHASHTHI 20:24 N: MULA 24:17+ VA: 22:29-24:17+ RK: 11:24-12:47 YG: 15:34-16:57 SR: 07:14 SS: 18:21	<b>17</b> T: SAPTAMI 22:57 N: P.ASHADHA 27:19+ VA: 11:05-12:54 RK: 10:01-11:24 YG: 14:10-15:33 SR: 07:15 SS: 18:19
<b>18</b> T: ASHTAMI 25:21+ N: U.ASHADHA 30:08+ VA: 12:15-14:02 RK: 16:55-18:18 YG: 12:47-14:10 SR: 07:16 SS: 18:18	<b>19</b> T: NAVAMI 27:20+ N: SHRAVANA FULL NIGHT VA: 10:32-12:18 RK: 08:39-10:02 YG: 11:24-12:47 SR: 07:17 SS: 18:17	<b>20</b> T: DASHAMI 28:41+ N: SHRAVANA 08:32 VA: 12:49-14:32 RK: 15:31-16:53 YG: 10:02-11:24 SR: 07:18 SS: 18:15	<b>21</b> T: EKADASHI 29:17+ N: DHANISHTHA 10:18 VA: 17:48-19:28 RK: 12:46-14:08 YG: 08:41-10:03 SR: 07:19 SS: 18:14	<b>22</b> T: DWADASHI 29:05+ N: SHATABHISHA 11:19 VA: 17:46-19:23 RK: 14:08-15:29 YG: 07:20-08:42 SR: 07:20 SS: 18:12	<b>23</b> T: TRAYODASHI 28:06+ N: P.BHADRAPADA 11:33 VA: 20:56-22:30 RK: 11:25-12:46 YG: 15:28-16:50 SR: 07:21 SS: 18:11	<b>24</b> T: CHATURDASHI 26:25+ N: U.BHADRAPADA 11:02 VA: 22:27-23:58 RK: 10:04-11:25 YG: 14:07-15:28 SR: 07:22 SS: 18:10
<b>25</b> T: PURNIMA 24:11+ N: REVATI 09:52 VA: 28:28+29:57+ RK: 16:48-18:08 YG: 12:46-14:06 SR: 07:23 SS: 18:08	<b>26</b> T: PRATIPADA 21:31 N: ASHWINI 08:11 VA: 16:58-18:26 RK: 08:45-10:05 YG: 11:25-12:46 SR: 07:25 SS: 18:07	<b>27</b> T: DWITIYA 18:36 N: KRITTIKA 27:56+ VA: 17:02-18:29 RK: 15:26-16:46 YG: 10:06-11:26 SR: 07:26 SS: 18:06	<b>28</b> T: TRITIYA 15:36 N: ROHINI 25:41+ VA: 18:26-19:53 VA: 30:47+08:15 on 29th RK: 12:46-14:05 YG: 08:46-10:06 SR: 07:27 SS: 18:04	<b>29</b> T: CHATURTHI 12:39 N: MRIGASHIRA 23:34 VA: 31:19+08:47 on 30th RK: 14:05-15:24 YG: 07:28-08:47 SR: 07:28 SS: 18:03	<b>30</b> T: PANCHAMI 09:54 T: SHASHTHI 31:27+ N: ARDRA 21:42 VA: 11:26-12:45 YG: 15:24-16:43 SR: 07:29 SS: 18:02	<b>31</b> T: SAPTAMI 28:21+ N: PUNARVASU 20:09 VA: 08:55-10:25 VA: 26:46+28:18+ RK: 10:08-11:27 YG: 14:04-15:23 SR: 07:30 SS: 18:01

PANCHANGA BY DR. MURALI BHUVANAGIRI CALCULATED AS PER MALVERN, PA, USA'S LONGITUDE & LATITUDE, WHEN TITHI OR NAKSHATRA ENDS PAST MIDNIGHT "MON/DATE" IS INDICATED AS HINDU DAY IS FROM ONE SUNRISE TO ANOTHER SUNRISE. TITHI, NAKSHATRA TIMINGS ARE END TIMES, WHEN ONE ENDS ANOTHER BEGINS. '+' SYMBOL INDICATES NEXT DAY

**THE MORTGAGEIST**  
YOUR MORTGAGE SPECIALIST

**Apeksha Sista** NMLS# 2692605  
**(610) 836-2332**  
Your Very Own Loan Officer

**Kumar Sista** NMLS# 2369551  
**(610) 618-0618**

The Mortgageist, NMLS# 2710734, 150 Allendale Rd, Ste. 2200, King of Prussia, PA 19406

**EXPERIOR**  
FINANCIAL GROUP, INC

**Srikanth Katupilla**  
724 689 7999  
skatupilla@experiorfincialgroup.com

**Ashish Joshi**  
717 395 6154  
ajoshi@experiorfincialgroup.com

- College Saving Plans
- Tax Saving Plans
- Mortgage Protection
- Retirement Strategies
- Business Coaching & Mentoring

Estate Planning / Will and Trust  
Credit Score Fix Services  
Wealth building, protection & recovery  
Legal Protection Services  
Life Insurance & Long term Care

**Every Monday 6:30 pm**  
**Shiva Abhishekam**

**Every Thursday 10:30 am**  
**Baba Abhishekam**

**Every 2nd Tuesday 6:30 pm**  
**Muragan Abhishekam**

**Every 1st Friday 6:30 pm**  
**Sri Chakra Abhishekam**

**Every**  
**Saturday 10:30 am**  
**Balaji Abhishekam**

**Every Sankatahara**  
**Chaturthi 6:30 pm**  
**Ganapathi Abhishekam**

**Every Full Moon day**  
**Group Satyanarayana**  
**Vratam**

**Every Last**  
**Saturday 6:30 pm**  
**Ayyappa Padi Pooja**





# SAI TEMPLE MALVERN



# NOVEMBER 2026



170 Planebrook Rd, Malvern, PA 19355  
Tel : 610-296-2039, 510-644-2596  
www.saitemplemalvern.com  
info@saitemplepa.com

PARABHAVA, AYANA : DAKSHINA, RITU : HEMANT, ASHVAYUJA - KARTIKA, TULA - VRISCHIKA, AIPPASI - KARTHIKAI

## SUN (BHANU) MON (INDU) TUE (BHAUMA) WED (SAUMYA) THU (BRUHASPATHI) FRI (BHRUGU) SAT (STHIRA)

<b>1</b> <b>T:</b> ASHTAMI 26:40+ <b>N:</b> PUSHYA 18:00 <b>VA:</b> 30:25+07:58 on 2 <sup>nd</sup> <b>RK:</b> 15:41-16:59 <b>YG:</b> 11:45-13:04 <b>SR:</b> 06:31 <b>SS:</b> 16:59	<b>2</b> <b>T:</b> NAVAMI 25:24+ <b>N:</b> ASHLESHA 17:16 <b>VA:</b> 29:06+06:41 on 3 <sup>rd</sup> <b>RK:</b> 07:51-09:09 <b>YG:</b> 10:27-11:45 <b>SR:</b> 06:32 <b>SS:</b> 16:58	<b>3</b> <b>T:</b> DASHAMI 24:33+ <b>N:</b> MAGHA 16:56 <b>VA:</b> 24:57+26:34+ <b>RK:</b> 14:21-15:39 <b>YG:</b> 09:09-10:27 <b>SR:</b> 06:34 <b>SS:</b> 16:57	<b>4</b> <b>T:</b> EKADASHI 24:05+ <b>N:</b> P.PHALGUNI 17:00 <b>VA:</b> 24:19+25:57+ <b>RK:</b> 11:45-13:03 <b>YG:</b> 07:52-09:10 <b>SR:</b> 06:35 <b>SS:</b> 16:56	<b>5</b> <b>T:</b> DWADASHI 24:00 <b>N:</b> U.PHALGUNI 17:25 <b>VA:</b> 26:06+27:45+ <b>RK:</b> 13:03-14:20 <b>YG:</b> 06:36-07:53 <b>SR:</b> 06:36 <b>SS:</b> 16:55	<b>6</b> <b>T:</b> TRAYODASHI 24:17+ <b>N:</b> HASTA 18:13 <b>VA:</b> 26:36+28:17+ <b>RK:</b> 10:28-11:45 <b>YG:</b> 14:20-15:37 <b>SR:</b> 06:37 <b>SS:</b> 16:54	<b>7</b> <b>T:</b> CHATURDASHI 24:57+ <b>N:</b> CHITRA 19:22 <b>VA:</b> 25:19+27:02+ <b>RK:</b> 09:12-10:29 <b>YG:</b> 13:02-14:19 <b>SR:</b> 06:38 <b>SS:</b> 16:53
<b>8</b> <b>T:</b> AMAVASYA 26:01+ <b>N:</b> SWATI 20:54 <b>VA:</b> 26:57+28:40+ <b>RK:</b> 15:35-16:52 <b>YG:</b> 11:46-13:02 <b>SR:</b> 06:39 <b>SS:</b> 16:52	<b>9</b> <b>T:</b> PRATIPADA 27:30+ <b>N:</b> VISHAKHA 22:49 <b>VA:</b> 27:12+28:57+ <b>RK:</b> 07:57-09:13 <b>YG:</b> 10:29-11:46 <b>SR:</b> 06:40 <b>SS:</b> 16:51	<b>10</b> <b>T:</b> DWITIYA 29:23+ <b>N:</b> ANURADHA 25:08+ <b>VA:</b> 14:18-15:34 <b>RK:</b> 09:14-10:30 <b>YG:</b> 09:14-10:30 <b>SR:</b> 06:42 <b>SS:</b> 16:50	<b>11</b> <b>T:</b> TRITIYA FULL NIGHT <b>N:</b> JYESHTHA 27:49+ <b>VA:</b> 07:21-09:08 <b>RK:</b> 11:46-13:02 <b>YG:</b> 07:58-09:14 <b>SR:</b> 06:43 <b>SS:</b> 16:49	<b>12</b> <b>T:</b> TRITIYA 07:39 <b>N:</b> MULA FULL NIGHT <b>VA:</b> 12:48-14:36 <b>VA:</b> 28:59+06:47 on 13 <sup>th</sup> <b>RK:</b> 13:01-14:17 <b>YG:</b> 06:44-07:59 <b>SR:</b> 06:44 <b>SS:</b> 16:48	<b>13</b> <b>T:</b> CHATURTHI 10:12 <b>N:</b> MULA 06:47 <b>VA:</b> 17:38-19:26 <b>RK:</b> 10:31-11:46 <b>YG:</b> 14:17-15:32 <b>SR:</b> 06:45 <b>SS:</b> 16:47	<b>14</b> <b>T:</b> PANCHAMI 12:53 <b>N:</b> P.ASHADHA 09:54 <b>VA:</b> 18:55-20:44 <b>RK:</b> 09:16-10:31 <b>YG:</b> 13:01-14:16 <b>SR:</b> 06:46 <b>SS:</b> 16:46
<b>15</b> <b>T:</b> SHASHTHI 15:30 <b>N:</b> U.ASHADHA 12:58 <b>VA:</b> 17:26-19:14 <b>RK:</b> 15:31-16:46 <b>YG:</b> 11:46-13:01 <b>SR:</b> 06:47 <b>SS:</b> 16:46	<b>16</b> <b>T:</b> SAPTAMI 17:49 <b>N:</b> SHRAVANA 15:46 <b>VA:</b> 20:09-21:55 <b>RK:</b> 08:03-09:18 <b>YG:</b> 10:32-11:47 <b>SR:</b> 06:48 <b>SS:</b> 16:45	<b>17</b> <b>T:</b> ASHTAMI 19:34 <b>N:</b> DHANISHTHA 18:04 <b>VA:</b> 25:45+27:27+ <b>RK:</b> 14:15-15:30 <b>YG:</b> 09:18-10:32 <b>SR:</b> 06:50 <b>SS:</b> 16:44	<b>18</b> <b>T:</b> NAVAMI 20:35 <b>N:</b> SHATABHISHA 19:40 <b>VA:</b> 26:16+27:55+ <b>RK:</b> 11:47-13:01 <b>YG:</b> 08:05-09:19 <b>SR:</b> 06:51 <b>SS:</b> 16:43	<b>19</b> <b>T:</b> DASHAMI 20:45 <b>N:</b> P.BHADRAPADA 20:26 <b>VA:</b> 30:00+07:35 on 20 <sup>th</sup> <b>RK:</b> 13:01-14:15 <b>YG:</b> 06:52-08:06 <b>SR:</b> 06:52 <b>SS:</b> 16:43	<b>20</b> <b>T:</b> EKADASHI 20:01 <b>N:</b> U.BHADRAPADA 20:20 <b>RK:</b> 10:34-11:47 <b>YG:</b> 14:15-15:28 <b>SR:</b> 06:53 <b>SS:</b> 16:42	<b>21</b> <b>T:</b> DWADASHI 18:26 <b>N:</b> REVATI 19:24 <b>VA:</b> 07:52-09:25 <b>RK:</b> 09:21-10:34 <b>YG:</b> 13:01-14:15 <b>SR:</b> 06:54 <b>SS:</b> 16:41
<b>22</b> <b>T:</b> TRAYODASHI 16:07 <b>N:</b> ASHWINI 17:45 <b>VA:</b> 14:02-15:31 <b>VA:</b> 26:28+27:55+ <b>RK:</b> 15:28-16:41 <b>YG:</b> 11:48-13:01 <b>SR:</b> 06:55 <b>SS:</b> 16:41	<b>23</b> <b>T:</b> CHATURDASHI 13:12 <b>N:</b> BHARANI 15:32 <b>VA:</b> 26:13+27:39+ <b>RK:</b> 08:09-09:22 <b>YG:</b> 10:35-11:48 <b>SR:</b> 06:56 <b>SS:</b> 16:40	<b>24</b> <b>T:</b> PURNIMA 09:53 <b>T:</b> PRATIPADA 30:20+ <b>N:</b> KRITTIKA 12:55 <b>VA:</b> 27:02+28:27+ <b>RK:</b> 14:14-15:27 <b>YG:</b> 09:23-10:36 <b>SR:</b> 06:57 <b>SS:</b> 16:40	<b>25</b> <b>T:</b> DWITIYA 26:45+ <b>N:</b> ROHINI 10:06 <b>VA:</b> 15:02-16:27 <b>RK:</b> 11:49-13:01 <b>YG:</b> 08:11-09:24 <b>SR:</b> 06:59 <b>SS:</b> 16:39	<b>26</b> <b>T:</b> TRITIYA 23:18 <b>N:</b> MRIGASHIRA 07:17 <b>N:</b> ARDRA 28:38+ <b>VA:</b> 14:45-16:11 <b>RK:</b> 13:02-14:14 <b>YG:</b> 07:00-08:12 <b>SR:</b> 07:00 <b>SS:</b> 16:39	<b>27</b> <b>T:</b> CHATURTHI 20:09 <b>N:</b> PUNARVASU 26:20+ <b>VA:</b> 15:29-16:56 <b>RK:</b> 10:37-11:50 <b>YG:</b> 14:14-15:26 <b>SR:</b> 07:01 <b>SS:</b> 16:38	<b>28</b> <b>T:</b> PANCHAMI 17:26 <b>N:</b> PUSHYA 24:29+ <b>VA:</b> 09:43-11:11 <b>RK:</b> 09:26-10:38 <b>YG:</b> 13:02-14:14 <b>SR:</b> 07:02 <b>SS:</b> 16:38
<b>29</b> <b>T:</b> SHASHTHI 15:16 <b>N:</b> ASHLESHA 23:12 <b>VA:</b> 12:36-14:07 <b>RK:</b> 15:26-16:38 <b>YG:</b> 11:50-13:02 <b>SR:</b> 07:03 <b>SS:</b> 16:38	<b>30</b> <b>T:</b> SAPTAMI 13:41 <b>N:</b> MAGHA 22:30 <b>VA:</b> 10:51-12:24 <b>VA:</b> 30:28+08:04 on 1 <sup>st</sup> <b>RK:</b> 08:15-09:27 <b>YG:</b> 10:39-11:51 <b>SR:</b> 07:04 <b>SS:</b> 16:37	<b>FESTIVALS</b> 04 RAMA EKADASHI 05 GOVATSA DWADASHI 06 DHANTERAS PRADOSHA VRATAM MASA SHIVARATRI	07 NARAK CHATURDASHI 08 DEEPAVALI LAKSHMI PUJA KEDAR GAURI VRATAM 12 NAGULA CHAVITHI 14 SKANDA SASHTI	15 CHHATH PUJA 16 VRISHCHIKA SANKRANTI 20 GURUVAYUR EKADASHI DEVUTTHANA EKADASHI 21 SHANI TRAYODASHI PRADOSHA VRATAM	22 VAIKUNTHA CHATURDASHI 24 KARTIKA PURNIMA VRATAM 27 SANKATAHARA CHATURTHI	

PANCHANGA BY DR. MURALI BHUVANAGIRI CALCULATED AS PER MALVERN, PA, USA'S LONGITUDE & LATITUDE, WHEN TITHI OR NAKSHATRA ENDS PAST MIDNIGHT "MON/DATE" IS INDICATED AS HINDU DAY IS FROM ONE SUNRISE TO ANOTHER SUNRISE. TITHI, NAKSHATRA TIMINGS ARE END TIMES, WHEN ONE ENDS ANOTHER BEGINS. '+' SYMBOL INDICATES NEXT DAY

**THE MORTGAGEIST**  
YOUR MORTGAGE SPECIALIST

**Apeksha Sista** NMLS# 2692605  
**(610) 836-2332**

**Kumar Sista** NMLS# 2369551  
**(610) 618-0618**

Your Very Own Loan Officer

The Mortgageist, NMLS# 2710734, 150 Allendale Rd, Ste. 2200, King of Prussia, PA 19406

**EXPERIOR**  
FINANCIAL GROUP, INC

**Srikanth Katupilla**  
724 689 7999  
skatupilla@experiorfincialgroup.com

**Ashish Joshi**  
717 395 6154  
ajoshi@experiorfincialgroup.com

- College Saving Plans
- Tax Saving Plans
- Mortgage Protection
- Retirement Strategies
- Business Coaching & Mentoring

Estate Planning / Will and Trust  
Credit Score Fix Services  
Wealth building, protection & recovery  
Legal Protection Services  
Life Insurance & Long term Care

Every  
Monday 6:30 pm  
Shiva Abhishekam

Every  
Thursday 10:30 am  
Baba Abhishekam

Every  
2nd Tuesday 6:30 pm  
Muragan Abhishekam

Every  
1st Friday 6:30 pm  
Sri Chakra  
Abhishekam

Every  
Saturday 10:30 am  
Balaji Abhishekam



Every  
Sankatahara  
Chaturthi 6:30 pm  
Ganapathi  
Abhishekam

Every  
Full Moon day  
Group  
Satyanarayana  
Vratam

Every Last  
Saturday 6:30 pm  
Ayyappa Padi Pooja



# SAI TEMPLE MALVERN



# DECEMBER 2026



170 Planebrook Rd, Malvern, PA 19355  
Tel : 610-296-2039, 510-644-2596  
www.saitemplemalvern.com  
info@saitemplepa.com

PARABHAVA, AYANA : DAKSHINA – UTTARA, RITU : HEMANT - SHISHIRA, KARTIKA – MARGASIRA, VRISCHIKA - DHANUSH, KARTHIKAI - MARGAZHI

## SUN (BHANU) MON (INDU) TUE (BHAUMA) WED (SAUMYA) THU (BRUHASPATHI) FRI (BHRUGU) SAT (STHIRA)

<b>FESTIVALS</b> 04 UTPANNA EKADASHI 05 SHANI TRAYODASHI PRADOSHA VRATAM 06 MASA SHIVARATRI 13 NAGA PANCHAMI*TELUGU	14 SUBRAHMANYA SASHTI SKANDA SASHTI 15 DHANU SANKRANTI 19 GITA JAYANTI MOKSHADA EKADASHI 20 ВАIKUNTHA EKADASHI	<b>1</b> T: ASHTAMI 12:43 N: P.PHALGUNI 22:25 VA: 29:45+07:23 on 2 <sup>nd</sup> RK: 14:14-15:26 YG: 09:28-10:39 SR: 07:05 SS: 16:37	<b>2</b> T: NAVAMI 12:21 N: U.PHALGUNI 22:53 RK: 11:51-13:03 YG: 08:17-09:29 SR: 07:06 SS: 16:37	<b>3</b> T: DASHAMI 12:33 N: HASTA 23:52 VA: 07:38-09:18 RK: 13:03-14:14 YG: 07:07-08:18 SR: 07:07 SS: 16:37	<b>4</b> T: EKADASHI 13:14 N: CHITRA 25:18+ VA: 08:21-10:03 RK: 10:41-11:52 YG: 14:14-15:25 SR: 07:08 SS: 16:37	<b>5</b> T: DWADASHI 14:21 N: SWATI 27:08+ VA: 07:20-09:03 RK: 09:31-10:42 YG: 13:04-14:15 SR: 07:09 SS: 16:37
<b>6</b> T: TRAYODASHI 15:52 N: VISHAKHA 29:18+ VA: 09:14-10:59 RK: 15:26-16:36 YG: 11:53-13:04 SR: 07:10 SS: 16:36	<b>7</b> T: CHATURDASHI 17:42 N: ANURADHA FULL NIGHT VA: 09:42-11:28 RK: 08:21-09:32 YG: 10:43-11:53 SR: 07:10 SS: 16:36	<b>8°</b> T: AMAVASYA 19:51 N: ANURADHA 07:46 VA: 14:00-15:47 RK: 14:15-15:26 YG: 09:33-10:43 SR: 07:11 SS: 16:36	<b>9</b> T: PRATIPADA 22:15 N: JYESHTHA 10:30 VA: 19:29-21:17 RK: 11:54-13:05 YG: 08:23-09:33 SR: 07:12 SS: 16:36	<b>10</b> T: DWITIYA 24:52+ N: MULA 13:28 VA: 11:40-13:28 RK: 11:58-13:08 YG: 08:28-09:38 SR: 07:17 SS: 16:38	<b>11</b> T: TRITIYA 27:36+ N: P.ASHADHA 16:34 VA: 25:36+27:25+ RK: 10:45-11:55 YG: 14:16-15:26 SR: 07:14 SS: 16:37	<b>12</b> T: CHATURTHI 30:17+ N: U.ASHADHA 19:42 VA: 24:12+26:00+ RK: 09:35-10:45 YG: 13:06-14:16 SR: 07:15 SS: 16:37
<b>13</b> T: PANCHAMI FULL NIGHT N: SHRAVANA 22:42 VA: 27:09+28:55+ RK: 15:27-16:37 YG: 11:56-13:06 SR: 07:15 SS: 16:37	<b>14</b> T: PANCHAMI 08:45 N: DHANISHTHA 25:22+ VA: 08:26-09:36 YG: 10:47-11:57 SR: 07:16 SS: 16:37	<b>15</b> T: SHASHTHI 10:49 N: SHATABHISHA 27:32+ VA: 09:13-10:58 RK: 14:17-15:27 YG: 09:37-10:47 SR: 07:17 SS: 16:38	<b>16</b> T: SAPTAMI 12:15 N: P.BHADRAPADA 29:00+ VA: 10:20-12:01 RK: 11:58-13:08 YG: 08:28-09:38 SR: 07:17 SS: 16:38	<b>17</b> T: ASHTAMI 12:55 N: U.BHADRAPADA 29:40+ VA: 14:52-16:31 RK: 13:08-14:18 YG: 07:18-08:28 SR: 07:18 SS: 16:38	<b>18</b> T: NAVAMI 12:44 N: REVATI 29:28+ VA: 17:34-19:09 RK: 10:49-11:59 YG: 14:19-15:29 SR: 07:19 SS: 16:39	<b>19</b> T: DASHAMI 11:39 N: ASHWINI 28:25+ VA: 24:36+26:07+ RK: 09:39-10:49 YG: 13:09-14:19 SR: 07:19 SS: 16:39
<b>20</b> T: EKADASHI 09:44 T: DWADASHI 31:06+ N: BHARANI 26:38+ VA: 13:18-14:47 RK: 15:29-16:39 YG: 12:00-13:10 SR: 07:20 SS: 16:39	<b>21</b> T: TRAYODASHI 27:53+ N: KRITTIKA 24:15+ VA: 13:27-14:53 RK: 08:30-09:40 YG: 10:50-12:00 SR: 07:20 SS: 16:40	<b>22</b> T: CHATURDASHI 24:17+ N: ROHINI 21:26 VA: 14:22-15:47 RK: 14:21-15:30 YG: 09:41-10:51 SR: 07:21 SS: 16:40	<b>23</b> T: PURNIMA 20:27 N: MRIGASHIRA 18:23 VA: 25:42+27:05+ RK: 12:01-13:11 YG: 08:31-09:41 SR: 07:21 SS: 16:41	<b>24</b> T: PRATIPADA 16:37 N: ARDRA 15:17 VA: 25:48+27:12+ RK: 13:12-14:22 YG: 07:22-08:32 SR: 07:22 SS: 16:42	<b>25</b> T: DWITIYA 12:55 N: PUNARVASU 12:20 VA: 19:27-20:53 RK: 10:52-12:02 YG: 14:22-15:32 SR: 07:22 SS: 16:42	<b>26</b> T: TRITIYA 09:34 T: CHATURTHI 30:42+ N: PUSHYA 09:42 VA: 21:22-22:49 RK: 09:43-10:53 YG: 13:13-14:23 SR: 07:23 SS: 16:43
<b>27</b> T: PANCHAMI 28:27+ N: ASHLESHA 07:34 N: MAGHA 30:02+ VA: 18:48-20:18 RK: 15:33-16:43 YG: 12:03-13:13 SR: 07:23 SS: 16:43	<b>28</b> T: SHASHTHI 26:54+ N: P.PHALGUNI 29:13+ VA: 13:46-15:19 RK: 08:33-09:43 YG: 10:54-12:04 SR: 07:23 SS: 16:44	<b>29</b> T: SAPTAMI 26:06+ N: U.PHALGUNI 29:06+ VA: 12:23-13:58 RK: 14:24-15:35 YG: 09:44-10:54 SR: 07:23 SS: 16:45	<b>30</b> T: ASHTAMI 26:02+ N: HASTA 29:43+ VA: 13:43-15:22 RK: 12:05-13:15 YG: 08:34-09:44 SR: 07:24 SS: 16:46	<b>31</b> T: NAVAMI 26:39+ N: CHITRA 30:59+ VA: 14:08-15:49 RK: 13:15-14:26 YG: 07:24-08:34 SR: 07:24 SS: 16:46	<b>FESTIVALS</b> 20 MATSYA DWADASHI 21 PRADOSHA VRATAM 23 DATTATREYA JAYANTI PURNIMA VRATAM 26 SANKATAHARA CHATURTHI	

PANCHANGA BY DR. MURALI BHUVANAGIRI CALCULATED AS PER MALVERN, PA, USA'S LONGITUDE & LATITUDE, WHEN TITHI OR NAKSHATRA ENDS PAST MIDNIGHT "MON/DATE" IS INDICATED AS HINDU DAY IS FROM ONE SUNRISE TO ANOTHER SUNRISE. TITHI, NAKSHATRA TIMINGS ARE END TIMES, WHEN ONE ENDS ANOTHER BEGINS. '+' SYMBOL INDICATES NEXT DAY

**THE MORTGAGEIST**  
YOUR MORTGAGE SPECIALIST

**Apeksha Sista** NMLS# 2692605  
**(610) 836-2332**

**Kumar Sista** NMLS# 2369551  
**(610) 618-0618**

Your Very Own Loan Officer

The Mortgageist, NMLS# 2710734, 150 Allendale Rd, Ste. 2200, King of Prussia, PA 19406

**EXPERIOR**  
FINANCIAL GROUP, INC

**Srikanth Katupilla**  
724 689 7999  
skatupilla@experiorfinancialgroup.com

**Ashish Joshi**  
717 395 6154  
ajoshi@experiorfinancialgroup.com

- College Saving Plans
- Tax Saving Plans
- Mortgage Protection
- Retirement Strategies
- Business Coaching & Mentoring

Estate Planning / Will and Trust  
Credit Score Fix Services  
Wealth building, protection & recovery  
Legal Protection Services  
Life Insurance & Long term Care



**United**  
Real Estate

908-727-0902

484-367-7727

ShantaRealtor@gmail.com

www.Serenity-Realty.com

150 Allendale Rd.  
King of Prussia, PA 19406

Each Office Independently Owned and Operated

**Shanta Aitha**  
REALTOR®



Shital Shah  
Insurance Agent

## New York Life Insurance Company

100 Witmer Road  
Suite 100

Horsham, PA 19044

Bus: 215 441 6562

Direct : 267 272 0032

Email: [sbshah@ft.newyorklife.com](mailto:sbshah@ft.newyorklife.com)

- Life Insurance
- Buy/Sell Agreements
- College/Education Funding
- Mortgage Protection using Life Insurance
- Estate Conservation
- Retirement Planning

## KINNERA INDIAN CUISINE

235 Lancaster Ave E-12 Malvern PA

kinnera.ic@gmail.com

215-606-9999



**Enjamuri Swamy**

Real Estate Agent  
In PA, DE & NJ



Cell : 484-857-9269

Office : 215-583-7777 Ext. 485  
swamyen@yahoo.com

Realty Mark Cityscape HV

2250 Terwood Drive, Huntingdon Valley, PA 19006

[www.realtymarkllc.com](http://www.realtymarkllc.com)

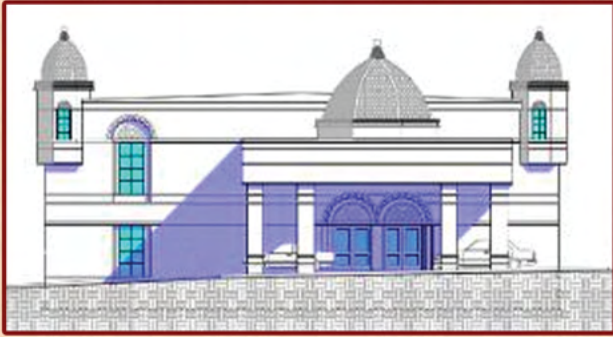

With the blessings of Bhagwan, we are overjoyed to share a meaningful step in our journey together. Our temple is moving forward with the next phase of building a new Sai Temple here in Pennsylvania, with construction planned to begin in 2026. This new temple will serve as a larger and more welcoming spiritual home for our growing community, a place where families can gather for darshan, bhajans, satsangs, children's programs, and cultural celebrations for generations to come.

As we begin this sacred work, we warmly invite all devotees to join us in strengthening this effort. Your prayers, your presence, your encouragement, and your support play a vital role in helping our community bring this dream to life. Every act of involvement, whether through seva or through contributions toward the building fund, helps us move closer to opening the doors of our new spiritual home.

We are deeply grateful for the love and support you have shown throughout this journey. May Bhagwan's grace continue to guide, uplift, and bless you and your families with peace, health, and happiness.

*With humble regards,*  
**Sai Temple INC**

## OUR PRIESTS



Head Priest **RATNA KUMAR RAVURI**

Phone Number : +1 (484) 569-0676

Spoken Languages : Telugu, Tamil, Hindi & English



**KESHAVA BHATTAR**

Phone Number : +1 (412) 273-5161

Spoken Languages : Kannada, Telugu, Tamil & English



**SUDHEER ACHARYA**

Phone Number : +1 (484) 815-9019

Spoken Languages : Telugu, Hindi, Tamil, Kannada & English

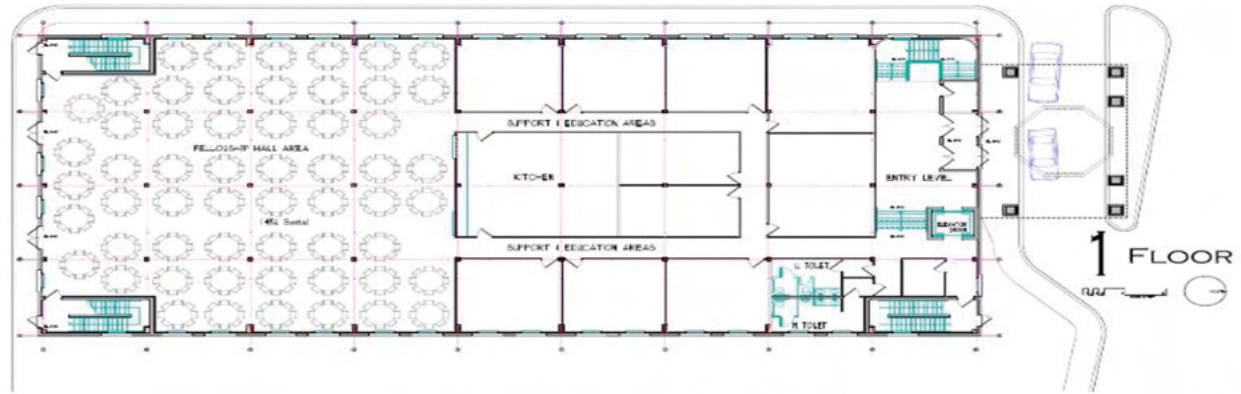

**PH**  
ARCHITECTS

MAIN ENTRY / NORTH ELEVATION

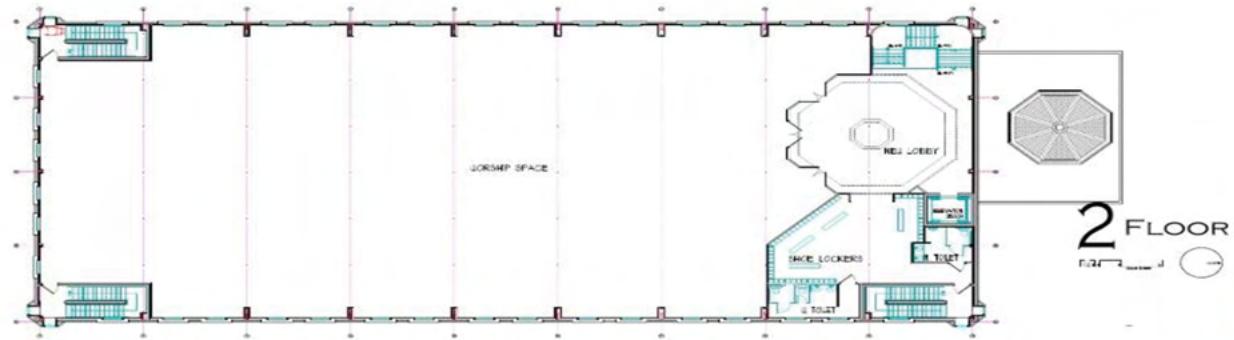

**PH**  
ARCHITECTS

PLANEBROOK RD. ELEVATION